

TS11-EN 10242



ekpaş®  
ekpas.com.tr

# Temper Dökme Demir fittingler

## Product range

1	1a	2	2a	3	40
41	85	87	90	90DT	90R
92	92R	95	96	97	98
120	121	130	130R	131	180
180R	240	241	245	246	270
270DT	271	280	290	291	300
310	330	331	340	341	370
371	372	374	529a	330 SB	330 PB

# Dişli Boru Bağlantı Parçaları (Fittingler)

Ürün standartları: TS-EN 10242

Trakya Döküm temper dökme demir fittingleri, Avrupa temper dökme demir fitting standardı EN 10242 Dizayn sembolü "A" ve uluslararası fitting standardı ISO 49 normlarına uygun olarak üretilmektedir.

Her iki standartta temper dökme demirden imal edilen dişli boru fittinglerin sahip olması gereken dizayn ve performans kriterlerini tanımlamaktadır.

Trakya Döküm fittingleri her iki standardın tüm gerekliliklerini yerine getirecek şekilde ve aşağıda belirtilen basınç ve sıcaklık limitlerinde tüm akışkan ve gazların (hava, su doğal gaz, sıvı yakıtlar vs.) taşınmasına uygun olarak üretilmektedir.

a) Normal uygulamalar

a1) Minimum çalışma sıcaklığı -20°C.

Minimum çalışma sıcaklığındaki basınç 25 bar.

a2) -20°C - 120°C sıcaklık aralığında maksimum çalışma basıncı 25 bar.

a3) 120°C - 300°C sıcaklık aralığında maksimum çalışma basıncı 25 - 20 bar aralığında. (Grafik 1)

b) Özel uygulamalar

-20°C'nin altındaki özel uygulamalar veya normal uygulamalar dışındaki diğer uygulamalar için Trakya Döküm'e danışılmalıdır.

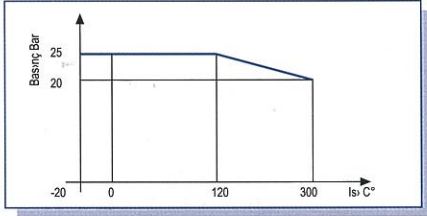

Grafik 1 : Basınç - sıcaklık ilişkisi  
Nota : 1 bar = 10<sup>5</sup> N/m<sup>2</sup> = 100kPa

## Teknik spesifikasyonlar

### Malzeme

Trakya Döküm fittingleri, EN 10242:1994 standardının "A" dizayn sembolüne uygun olarak siyah temper dökme malzemeden EN-GJMB-350-10 malzeme standardına uygun olarak üretilmektedir.

### Dişler

Trakya Döküm fittinglerinin dişleri ISO 7-1 normlarında belirtilen diş ölçülerine uygun olacak şekilde iç dişler paralel (Rp) ve dış dişler 1/16 konik (R) olarak imal edilmektedir.

ISO 228/1 standardına uygun dişler G ile sembolize edilmiştir.

### Nominal çap ve bağlantı ölçüleri

mm	6	8	10	15	20	25	32	40	50	65	80	100
"	1/8	1/4	3/8	1/2	3/4	1	1 1/4	1 1/2	2	2 1/2	3	4

### Yüzey Kaplama

Trakya Döküm fittingleri siyah veya daldırma galvaniz ile kaplanmış olarak ve korozyona açık yüzeylerin korunması amacı ile koruyucuyla kaplanmış şekilde kullanıma sunulmaktadır.

Galvanizli fittingler EN 10242:1994 standardına uygun olarak sıcak daldırma metodu ile minimum yüzey kaplama yoğunluğu 500gr/m<sup>2</sup>

ve minimum kaplama kalınlığı 70 µm olacak şekilde galvaniz ile kaplanmaktadır. Yüzey kaplamada kullanılan çinkonun saflığı nedeni ile Td fittingleri içme suyu uygulamaları için özellikle tavsiye edilmektedir.

### Boyutlar

Fittinglere ait boyutlar katalogta mevcuttur. Verilen boyutlar nominal değerlerdir.

### Ölçü tanımlaması

Fittinglerin tanımlanması en basit fittingler ile başlar ve bazı temel özellikler ile belirtilir.

Ölçülerin sıralamasında aşağıda belirtilen basit kural dizisi uygulanmıştır.

- Eşit çıkışlı fittingler için tek bir bağlantı ölçüsü vermek yeterlidir.
- İki farklı ölçüye sahip redüksiyon fittingler, önce büyük olan, daha sonra küçük ölçünün belirtilmesi ile tanımlanır.
- Üç ya da daha fazla bağlantıya sahip fittingler için (Resim 1 ve 4) önce girişin ölçüsü verilir, giriş ve çıkış ölçülerinin eşit olması durumunda, bunu dalın ölçüsü takip eder.
- Daralan bir çıkışın olduğu 3 çıkışlı fittinglerin ölçüleri 2 ve 3 no'lu resimlerde belirtilen sıra ile tanımlanır.

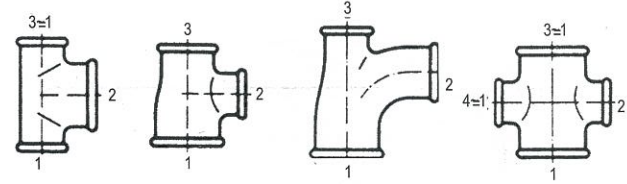

### Ağırlık Bilgisi

Bu katalogdaki indeks ve parça ağırlık değerleri sadece genel bilgi için verilmiştir. Verilen parça ağırlıkları nominal değerler olup, teknik sebeplerden dolayı parça ağırlıklarında farklılıklar olabilir.

### Düz Rakor

Düz rakorlar contasız olarak tedarik edilir. Göbekten dışa doğru sökülebilir ve tekrar biraraya getirilebilir.

### Sızdırmazlık

Sızdırmazlık için halkalı rakorların yatakları kullanılmadan önce temizlenmeli ve yağlanmalıdır. İçme suyu uygulamalarında ise, içme suyunda kullanıma uygun dış sızdırmazlık malzemesi ile (örneğin DIN 3066'a uygun dış sızdırmazlık pastası ile) temizlenmeli ve yağlanmalıdır.

### Kısaltmalar ve Tanımlar

SYH	Siyah
GAL	Galvanizli
*	Çelikten yapılan (yüzey kaplama=elektro galvaniz) ve içme suyunda kullanılmaya uygun olmayan fittingler.
KOD	Td parça numarası
ISO	ISO 49
Gr	Parça ağırlığı
G	Bağlama dişleri sızdırmazlığı ISO 228 standardında belirttiği gibi montaj yapılan dişler arasında sağlanamaz.
Fiyat	YTL/adet

### Sipariş Bilgileri

Td temper döküm fittingleri ( Dizayn Sembolü "A" ) aşağıdaki detaylar verilerek sipariş edilmelidir.

- 1.Td kodu
2. Miktar

# Introduction

Trakya Dokum, with its modern production facilities and experienced personnel, is the leading malleable cast iron fitting manufacturer in Turkey, producing fittings compliant with EN 10242 Design Symbol "A". High quality malleable cast iron fittings have been manufactured by Trakya Dokum since 1982 using modern machinery and equipment.

The fittings production line is equipped with a Disamatic 2013 Mk 4, Junker Presspour and main frequency melting furnaces. Special care has been taken to select modern sophisticated technology from Western Europe and the USA in all sections of sand preparation, core-making, fettling, heat treatment, galvanising, thread-cutting, laboratories and pattern-making, enabling the company to produce superior cast iron fittings for sales all around the world.

## Product standards

Td malleable cast iron fittings are in accordance with the current ISO 49 and EN 10242 standards and are designated with the design symbol A.

## Threads

Basic fitting threads are jointing threads, where ISO 7-1 applies. Internal threads are parallel (Rp) and external threads are 1:16 taper (R). Threads, which are fastening threads according to ISO 228/1, are marked with G on the symbol picture.

## Surface finish

Our Td malleable cast iron fittings are provided in black or hot dip galvanized finish, covered with a preservative for temporary prevention of rust film. Td fittings can be delivered in black or galvanized finish as requested by the purchaser. As prescribed by the standard EN 10242, the mass of zinc coating shall not be less than 500gr/m<sup>2</sup> which corresponds to a medium layer thickness of 70 µm.

"Fittings marked with (\*) are exceptions. They are made of steel and if a galvanized finish is required for these fittings, it can only be possible through electroplating for technical reasons"

## Dimensions

All dimensions, z-dimensions and other technical data can be found in the catalogue.

## Size designation

The naming of fitting types starts with the most basic type definition and some basic features follow that. As far as the sequence of connection sizes are concerned, the following simple set of rules applies.

- For equal fittings, individual connection size is sufficient
- For reducing fittings with 2 connections of different sizes, the connection size of the larger connection is given first, followed by the smaller connection.
- For fittings with 3 or more connections (illustrations 1 and 4), the throughput size is given first, and in the case of equal connections on the run, it is followed by the size of the branch.
- For 3 different connections or sections reduced in the run, the sequence for the designation of connections is according to illustrations 2 and 3.

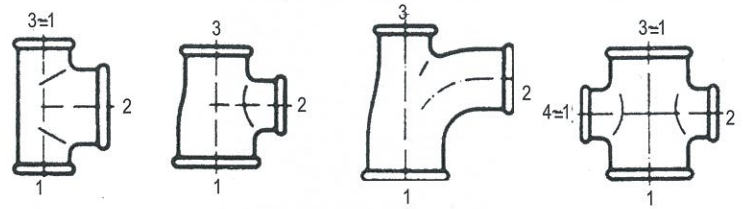

## Weight information

The weight values given in this catalogue are "nominal values". Differences in weight can occur in cast iron products for technical reasons.

## Flat seat unions

Flat seat unions are supplied without gaskets. They can be dismantled (radially) and re-assembled.

## Unions with metallic sealing

Seats of metallic sealing unions must be cleaned and greased before use. For potable water applications, they should be cleaned and lubricated with a potable water approved thread sealant (e.g. thread sealing paste complying to DIN 30660.)

## Quality testing/ leak test

Applying the standard EN 10242, each individual Td fitting is subjected to a pressure test with a minimum hydrostatic pressure of 20 bar, which is equivalent to a pneumatic pressure of minimum 5 bar.

## Key

BLK	Black
GAL	Galvanized
*	Types of fittings that are made of steel (galvanized finish = electro-plated) and unsuitable for potable water installations.
Code	Td part number
ISO	Designates ISO 49
Bag	Quantity per standard pack
Carton	Quantity per carton
Gr	~ Piece weight in grams
G	Fastening thread not sealing in the joint as defined by ISO 228.

## Ordering information

Td malleable cast iron fittings (Design Symbol A) should be ordered giving the following details :

1. Td code
2. Quantity

If it is not convenient to use the coding system, Td malleable cast iron fittings can also be ordered using individual feature definitions, as shown below:

## According to standard:

Elbow EN 10242 – A1 – 2 Zn – A

Elbow	type of fitting
EN 10242 (ISO 49)	standard
A1	symbol
2	fitting size
Zn	surface finish hot dip zinc coated
A	Design Symbol

## Trakya Döküm katalog numaraları ve ISO/EN sembollerinin eşleştirilmesi

### Correlation Trakya Döküm catalogue number - ISO/EN symbol

Trakya Döküm	ISO/EN	Trakya Döküm	ISO/EN
1	G4	245	N8 red
1a	D4	246	M4 red
2	G1	270	M2
2a	D1	271	M2 R-L
3	G8	280	N8
40	G4/45∞	290	T9
41	G1/45∞	291	T8
85		300	T1
87		310	P4
90	A1	330	U1
90R	A1	331	U2
92	A4	340	U11
92R	A4	341	U12
95	UA1	370	
96	UA11	371	
97	UA2	372	
98	UA12	374	
120	A1/45∞	529a	M4
121	A4/45∞		
130	B1		
130R	B1		
131	E1		
180	C1		
180R	C1		
240	M2 red		
241	N4		

Trakya Döküm katalog numaralarına göre sıralama

*Starting with Trakya Döküm Cat.Nr.*

ISO/EN	Trakya Döküm	ISO/EN	Trakya Döküm
A1	90	N8	280
A1	90R	N8 red	245
A1/45∞	120	P4	310
A4	92	T1	300
A4	92R	T8	291
A4/45∞	121	T9	290
B1	130	U1	330
B1	130R	U2	331
C1	180	U11	340
C1	180R	U12	341
D4	1a	UA1	95
E1	131	UA2	97
G1	2	UA11	96
G1/45∞	41	UA12	98
G4	1		
G4/45∞	40		
G8	3		
M2	270		
M2 R-L	271		
M2 red	240		
M4	529a		
M4 red	246		
N4	241		

ISO/EN sembollerine göre sıralama

*Starting with ISO/EN symbols*

## Dönüşüm Tablosu (inç-mm)

### Correlation of the inch and mm sizes

Fitting Ölçüsü <i>Fitting size</i>	1/8	1/4	3/8	1/2	3/4	1	1 1/4	1 1/2	2	2 1/2	3	4
Nominal Ölçü DN <i>Nominal size DN</i>	6	8	10	15	20	25	32	40	50	65	80	100

# 1

## ISO/EN (G4)

Deveboynu 90°  
(İç ve Dış vidalı)

Long sweep bend

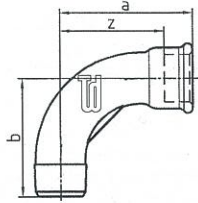

	Ölçü Size	Kod Code	Poşet Bag	Kutu Carton	Gr Gr
SYH	1/2	FS00010002	10	180	113
GLV	1/2	FG00010002	10	180	119
SYH	3/4	FS00010003	10	100	199
GLV	3/4	FG00010003	10	100	211
SYH	1	FS00010004		60	319
GLV	1	FG00010004		60	350
SYH	1 1/4	FS00010005		30	520
GLV	1 1/4	FG00010005		30	557
SYH	1 1/2	FS00010006		25	684
GLV	1 1/2	FG00010006		25	722
SYH	2	FS00010007		12	1404
GLV	2	FG00010007		12	1496

	Ölçü Size	Kod Code	a	b	z	z1
SYH	1/2	FS00010002	55	48	42	
GLV	1/2	FG00010002				
SYH	3/4	FS00010003	69	60	54	
GLV	3/4	FG00010003				
SYH	1	FS00010004	85	75	68	
GLV	1	FG00010004				
SYH	1 1/4	FS00010005	105	95	86	
GLV	1 1/4	FG00010005				
SYH	1 1/2	FS00010006	116	105	97	
GLV	1 1/2	FG00010006				
SYH	2	FS00010007	140	130	116	
GLV	2	FG00010007				

# 1a

## ISO/EN (D4)

Kısa Deveboynu  
İç ve Dış Dişli

Short bend

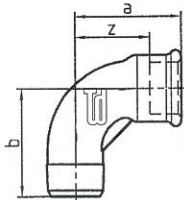

	Ölçü Size	Kod Code	Poşet Bag	Kutu Carton	Gr Gr
SYH	1/2	FS001A0002	10	180	120
GLV	1/2	FG001A0002	10	180	125
SYH	3/4	FS001A0003	10	100	200
GLV	3/4	FG001A0003	10	100	205
SYH	1	FS001A0004		60	330
GLV	1	FG001A0004		60	350
SYH	1 1/4	FS001A0005		30	530
GLV	1 1/4	FG001A0005		30	550
SYH	1 1/2	FS001A0006		25	705
GLV	1 1/2	FG001A0006		25	730
SYH	2	FS001A0007		12	1285
GLV	2	FG001A0007		12	1335

	Ölçü Size	Kod Code	a	b	z	z1
SYH	1/2	FS001A0002	45	45	32	
GLV	1/2	FG001A0002				
SYH	3/4	FS001A0003	50	50	35	
GLV	3/4	FG001A0003				
SYH	1	FS001A0004	63	63	46	
GLV	1	FG001A0004				
SYH	1 1/4	FS001A0005	76	76	57	
GLV	1 1/4	FG001A0005				
SYH	1 1/2	FS001A0006	85	85	66	
GLV	1 1/2	FG001A0006				
SYH	2	FS001A0007	102	102	78	
GLV	2	FG001A0007				

	Ölçü Size	Kod Code	Poşet Bag	Kutu Carton	Gr Gr
SYH	1/2	FS00020002	10	160	136
GLV	1/2	FG00020002	10	160	148
SYH	3/4	FS00020003	10	80	253
GLV	3/4	FG00020003	10	80	272
SYH	1	FS00020004		50	389
GLV	1	FG00020004		50	411
SYH	1 1/4	FS00020005		30	612
GLV	1 1/4	FG00020005		30	655
SYH	1 1/2	FS00020006		20	795
GLV	1 1/2	FG00020006		20	846
SYH	2	FS00020007		10	1519
GLV	2	FG00020007		10	1618

	Ölçü Size	Kod Code	a	b	z	z1
SYH	1/2	FS00020002	55		42	
GLV	1/2	FG00020002				
SYH	3/4	FS00020003	69		54	
GLV	3/4	FG00020003				
SYH	1	FS00020004	85		68	
GLV	1	FG00020004				
SYH	1 1/4	FS00020005	105		86	
GLV	1 1/4	FG00020005				
SYH	1 1/2	FS00020006	116		97	
GLV	1 1/2	FG00020006				
SYH	2	FS00020007	140		116	
GLV	2	FG00020007				

	Ölçü Size	Kod Code	Poşet Bag	Kutu Carton	Gr Gr
SYH	1/2	FS002A0002	10	160	140
GLV	1/2	FG002A0002	10	160	145
SYH	3/4	FS002A0003	10	80	235
GLV	3/4	FG002A0003	10	80	245
SYH	1	FS002A0004		50	385
GLV	1	FG002A0004		50	395
SYH	1 1/4	FS002A0005		30	645
GLV	1 1/4	FG002A0005		30	675
SYH	1 1/2	FS002A0006		20	830
GLV	1 1/2	FG002A0006		20	865
SYH	2	FS002A0007		10	1415
GLV	2	FG002A0007		10	1455
SYH	3	FS002A0009		4	2565
GLV	3	FG002A0009		4	2660

	Ölçü Size	Kod Code	a	b	z	z1
SYH	1/2	FS002A0002	45		32	
GLV	1/2	FG002A0002				
SYH	3/4	FS002A0003	50		35	
GLV	3/4	FG002A0003				
SYH	1	FS002A0004	63		46	
GLV	1	FG002A0004				
SYH	1 1/4	FS002A0005	76		57	
GLV	1 1/4	FG002A0005				
SYH	1 1/2	FS002A0006	85		66	
GLV	1 1/2	FG002A0006				
SYH	2	FS002A0007	102		78	
GLV	2	FG002A0007				
SYH	3	FS002A0009	127		97	
GLV	3	FG002A0009				

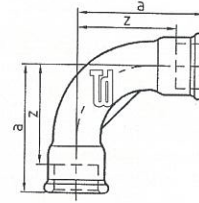
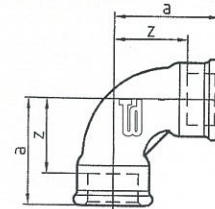
**2**
**ISO/EN (G1)**
**90° Deveboynu  
(İç vidalı)**
*Long sweep bend*

**2a**
**ISO/EN (D1)**
**Kısa Deveboynu  
(İç vidalı)**
*Short bend*

### 3

ISO/EN (G8)

90° Deveboynu  
(Dış vidalı)

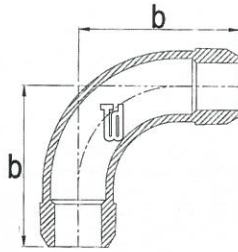
Long sweep bend



Ölçü Size	Kod Code	Poşet Bag	Kutu Carton	Gr Gr
SYH 1/2	FS00030002	10	180	95
GLV 1/2	FG00030002	10	180	100
SYH 3/4	FS00030003	10	100	175
GLV 3/4	FG00030003	10	100	190
SYH 1	FS00030004		60	340
GLV 1	FG00030004		60	360
SYH 1 1/4	FS00030005		30	540
GLV 1 1/4	FG00030005		30	575
SYH 1 1/2	FS00030006		25	740
GLV 1 1/2	FG00030006		25	780
SYH 2	FS00030007		12	1.400
GLV 2	FG00030007		12	1.460

Ölçü Size	Kod Code	a	b	z	z1
SYH 1/2	FS00030002		48		
GLV 1/2	FG00030002				
SYH 3/4	FS00030003		60		
GLV 3/4	FG00030003				
SYH 1	FS00030004		75		
GLV 1	FG00030004				
SYH 1 1/4	FS00030005		95		
GLV 1 1/4	FG00030005				
SYH 1 1/2	FS00030006		105		
GLV 1 1/2	FG00030006				
SYH 2	FS00030007		130		
GLV 2	FG00030007				

### 40

ISO/EN (G4/45°)

45° Deveboynu  
(İç ve dış vidalı)

45° Long sweep bend

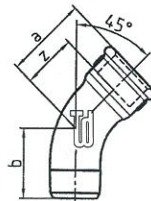

Ölçü Size	Kod Code	Poşet Bag	Kutu Carton	Gr Gr
SYH 1/2	FS00400002	10	180	108
GLV 1/2	FG00400002	10	180	112
SYH 3/4	FS00400003	10	100	175
GLV 3/4	FG00400003	10	100	180
SYH 1	FS00400004	10	60	280
GLV 1	FG00400004	10	60	295
SYH 1 1/4	FS00400005		30	575
GLV 1 1/4	FG00400005		30	605
SYH 1 1/2	FS00400006		25	620
GLV 1 1/2	FG00400006		25	655
SYH 2	FS00400007		12	1050
GLV 2	FG00400007		12	1110

Ölçü Size	Kod Code	a	b	z	z1
SYH 1/2	FS00400002	36	30	23	
GLV 1/2	FG00400002				
SYH 3/4	FS00400003	43	36	28	
GLV 3/4	FG00400003				
SYH 1	FS00400004	51	42	34	
GLV 1	FG00400004				
SYH 1 1/4	FS00400005	64	54	45	
GLV 1 1/4	FG00400005				
SYH 1 1/2	FS00400006	68	58	49	
GLV 1 1/2	FG00400006				
SYH 2	FS00400007	81	70	57	
GLV 2	FG00400007				



Ölçü Size	Kod Code	Poşet Bag	Kutu Carton	Gr Gr
SYH 1/2	FS00410002	10	160	137
GLV 1/2	FG00410002	10	160	146
SYH 3/4	FS00410003	10	80	219
GLV 3/4	FG00410003	10	80	235
SYH 1	FS00410004	10	50	333
GLV 1	FG00410004	10	50	350
SYH 1 1/4	FS00410005		30	570
GLV 1 1/4	FG00410005		30	617
SYH 1 1/2	FS00410006		20	718
GLV 1 1/2	FG00410006		20	760
SYH 2	FS00410007		10	1.310
GLV 2	FG00410007		10	1.355

Ölçü Size	Kod Code	a	b	z	z1
SYH 1/2	FS00410002	36		23	
GLV 1/2	FG00410002				
SYH 3/4	FS00410003	43		28	
GLV 3/4	FG00410003				
SYH 1	FS00410004	51		34	
GLV 1	FG00410004				
SYH 1 1/4	FS00410005	64		45	
GLV 1 1/4	FG00410005				
SYH 1 1/2	FS00410006	68		49	
GLV 1 1/2	FG00410006				
SYH 2	FS00410007	81		57	
GLV 2	FG00410007				

Ölçü Size	Kod Code	Poşet Bag	Kutu Carton	Gr Gr
SYH 1/2	FS00850002	10	100	186
GLV 1/2	FG00850002	10	100	195
SYH 3/4	FS00850003	10	70	297
GLV 3/4	FG00850003	10	70	308
SYH 1	FS00850004		40	499
GLV 1	FG00850004		40	528

Ölçü Size	Kod Code	a	d	z	z1
SYH 1/2	FS00850002	48	0.5in.	36	
GLV 1/2	FG00850002				
SYH 3/4	FS00850003	60	0.75in.	45	
GLV 3/4	FG00850003				
SYH 1	FS00850004	70	1in.	53	
GLV 1	FG00850004				

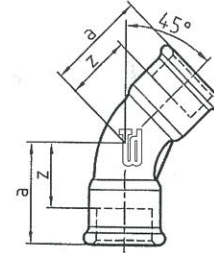
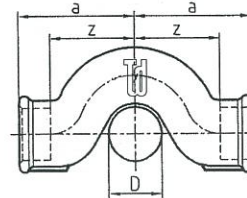
**41**
**ISO/EN (G1/45°)**
**45° Deveboynu  
(İç vidalı)**
**45° Long sweep  
bend**

**85**
**Boru Atlama  
Manşonu**
**Crossover**

# 87

Boru Atlama  
Te'si

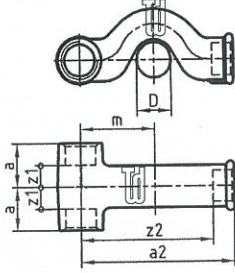
Tee, with  
crossover branch



	Ölçü Size	Kod Code	Poşet Bag	Kutu Carton	Gr Gr
SYH	1/2 "	FS00870002	10	80	220
GLV	1/2 "	FG00870002	10	80	230

	Ölçü Size	Kod Code	a	b	z	z1	D
SYH	1/2 "	FS00870002	26	93	13	80	0,5 in.
GLV	1/2 "	FG00870002	26	93	13	80	0,5 in.

# 90

ISO/EN(A1)

90° Dirsek

90° Elbow



90° Elbow

	Ölçü Size	Kod Code	Poşet Bag	Kutu Carton	Gr Gr
SYH	3/8 "	FS00900001	10	350	72
GLV	3/8 "	FG00900001	10	350	74
SYH	1/2 "	FS00900002	10	270	97
GLV	1/2 "	FG00900002	10	270	102
SYH	3/4 "	FS00900003	10	150	162
GLV	3/4 "	FG00900003	10	150	168
SYH	1 "	FS00900004	10	100	239
GLV	1 "	FG00900004	10	100	264
SYH	1 1/4 "	FS00900005	60	362	
GLV	1 1/4 "	FG00900005	60	380	
SYH	1 1/2 "	FS00900006	35	629	
GLV	1 1/2 "	FG00900006	35	650	
SYH	2 "	FS00900007	20	933	
GLV	2 "	FG00900007	20	994	
SYH	2 1/2 "	FS00900008	12	1.307	
GLV	2 1/2 "	FG00900008	12	1.376	
SYH	3 "	FS00900009	8	1.902	
GLV	3 "	FG00900009	8	2.021	
SYH	4 "	FS00900000	4	3.266	
GLV	4 "	FG00900000	4	3.326	

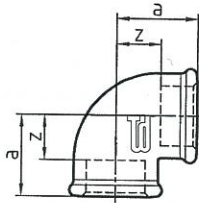

	Ölçü Size	Kod Code	a	b	z	z1
SYH	3/8 "	FS00900001	25		15	
GLV	3/8 "	FG00900001				
SYH	1/2 "	FS00900002	28		15	
GLV	1/2 "	FG00900002				
SYH	3/4 "	FS00900003	33		18	
GLV	3/4 "	FG00900003				
SYH	1 "	FS00900004	38		21	
GLV	1 "	FG00900004				
SYH	1 1/4 "	FS00900005	45		26	
GLV	1 1/4 "	FG00900005				
SYH	1 1/2 "	FS00900006	50		31	
GLV	1 1/2 "	FG00900006				
SYH	2 "	FS00900007	58		34	
GLV	2 "	FG00900007				
SYH	2 1/2 "	FS00900008	69		42	
GLV	2 1/2 "	FG00900008				
SYH	3 "	FS00900009	78		48	
GLV	3 "	FG00900009				
SYH	4 "	FS00900000	96		60	
GLV	4 "	FG00900000				

## 90DT

Doğalgaz Test  
Dirseği

Elbow

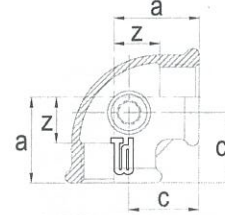

	Ölçü Size	Kod Code	Poşet Bag	Kutu Carton	Gr Gr
SYH	3/4	FS90DT0003		150	169
SYH	1	FS90DT0004		100	245
SYH	1 1/4	FS90DT0005		60	374
SYH	1 1/2	FS90DT0006		35	606
SYH	2	FS90DT0007		20	920

	Ölçü Size	Kod Code	a	b	z
SYH	3/4	FS90DT0003	33	27.5	18
SYH	1	FS90DT0004	38	30	21
SYH	1 1/4	FS90DT0005	45	36	26
SYH	1 1/2	FS90DT0006	50	41.5	31
SYH	2	FS90DT0007	58	47.5	34

## 90R ISO/EN(A1)

Redüksiyon  
Dirsek

Elbow

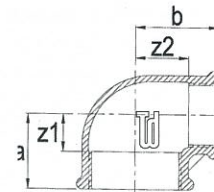

	Ölçü Size	Kod Code	Poşet Bag	Kutu Carton	Gr Gr
SYH	3/4-1/2 "	FS090R0032	10	150	136
GLV	3/4-1/2 "	FG090R0032	10	150	161
SYH	1-3/8 "	FS090R0041	10	120	195
GLV	1-3/8 "	FG090R0041	10	120	205
SYH	1-1/2 "	FS090R0042	10	120	190
GLV	1-1/2 "	FG090R0042	10	120	201
SYH	1-3/4 "	FS090R0043	10	100	219
GLV	1-3/4 "	FG090R0043	10	100	222
SYH	1 1/4-1/2 "	FS090R0052		45	290
GLV	1 1/4-1/2 "	FG090R0052		45	308
SYH	1 1/4-3/4 "	FS090R0053		45	239
GLV	1 1/4-3/4 "	FG090R0053		45	248
SYH	1 1/4-1 "	FS090R0054		40	375
GLV	1 1/4-1 "	FG090R0054		40	400
SYH	1 1/2-3/4 "	FS090R0063		40	402
GLV	1 1/2-3/4 "	FG090R0063		40	424
SYH	1 1/2-1 "	FS090R0064		40	438
GLV	1 1/2-1 "	FG090R0064		40	464
SYH	1 1/2-1 1/4 "	FS090R0065		40	467
GLV	1 1/2-1 1/4 "	FG090R0065		40	482
SYH	2-1 "	FS090R0074		35	700
GLV	2-1 "	FG090R0074		35	740
SYH	2-1 1/4 "	FS090R0075		35	590
GLV	2-1 1/4 "	FG090R0075		35	628
SYH	2-1 1/2 "	FS090R0076		30	698
GLV	2-1 1/2 "	FG090R0076		30	730

	Ölçü Size	Kod Code	a	b	z1	z2
SYH	3/4-1/2 "	FS090R0032	30	31	15	18
GLV	3/4-1/2 "	FG090R0032				
SYH	1-3/8 "	FS090R0041	32	34	12	21
GLV	1-3/8 "	FG090R0041				
SYH	1-1/2 "	FS090R0042	32	34	15	21
GLV	1-1/2 "	FG090R0042				
SYH	1-3/4 "	FS090R0043	35	36	18	21
GLV	1-3/4 "	FG090R0043				
SYH	1 1/4-1/2 "	FS090R0052	34	38	15	25
GLV	1 1/4-1/2 "	FG090R0052				
SYH	1 1/4-3/4 "	FS090R0053	36	41	17	26
GLV	1 1/4-3/4 "	FG090R0053				
SYH	1 1/4-1 "	FS090R0054	40	42	21	25
GLV	1 1/4-1 "	FG090R0054				
SYH	1 1/2-3/4 "	FS090R0063	38	44	19	29
GLV	1 1/2-3/4 "	FG090R0063				
SYH	1 1/2-1 "	FS090R0064	42	46	23	29
GLV	1 1/2-1 "	FG090R0064				
SYH	1 1/2-1 1/4 "	FS090R0065	46	48	27	29
GLV	1 1/2-1 1/4 "	FG090R0065				
SYH	2-1 "	FS090R0074	46	53	22	36
GLV	2-1 "	FG090R0074				
SYH	2-1 1/4 "	FS090R0075	48	53	24	33
GLV	2-1 1/4 "	FG090R0075				
SYH	2-1 1/2 "	FS090R0076	52	55	28	36
GLV	2-1 1/2 "	FG090R0076				

# 92

ISO/EN(A4)

90° Kuyruklu  
Dirsek

Elbow

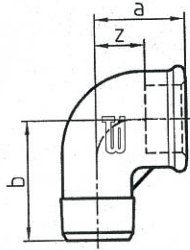

92 ISO/EN(A4) 90° Elbow

	Ölçü Size	Kod Code	Poşet Bag	Kutu Carton	Gr Gr
SYH	3/8 "	FS00920001	10	350	62
GLV	3/8 "	FG00920001	10	350	66
SYH	1/2 "	FS00920002	10	250	98
GLV	1/2 "	FG00920002	10	250	104
SYH	3/4 "	FS00920003	10	150	155
GLV	3/4 "	FG00920003	10	150	167
SYH	1 "	FS00920004	10	90	258
GLV	1 "	FG00920004	10	90	270
SYH	1 1/4 "	FS00920005		50	410
GLV	1 1/4 "	FG00920005		50	433
SYH	1 1/2 "	FS00920006		40	585
GLV	1 1/2 "	FG00920006		40	616
SYH	2 "	FS00920007		20	878
GLV	2 "	FG00920007		20	928
SYH	2 1/2 "	FS00920008		12	1.514
GLV	2 1/2 "	FG00920008		12	1.565
SYH	3 "	FS00920009		8	2.082
GLV	3 "	FG00920009		8	2.176
SYH	4 "	FS00920000		4	3.030
GLV	4 "	FG00920000		4	3.130

	Ölçü Size	Kod Code	a	b	c	z
SYH	3/8 "	FS00920001	25	32		15
GLV	3/8 "	FG00920001				
SYH	1/2 "	FS00920002	28	37		15
GLV	1/2 "	FG00920002				
SYH	3/4 "	FS00920003	33	43		18
GLV	3/4 "	FG00920003				
SYH	1 "	FS00920004	38	52		21
GLV	1 "	FG00920004				
SYH	1 1/4 "	FS00920005	45	60		26
GLV	1 1/4 "	FG00920005				
SYH	1 1/2 "	FS00920006	50	65		31
GLV	1 1/2 "	FG00920006				
SYH	2 "	FS00920007	58	74		34
GLV	2 "	FG00920007				
SYH	2 1/2 "	FS00920008	69	88		42
GLV	2 1/2 "	FG00920008				
SYH	3 "	FS00920009	78	98		48
GLV	3 "	FG00920009				
SYH	4 "	FS00920000	96	118		60
GLV	4 "	FG00920000				

# 92R

ISO/EN(A4)

Redüksiyon  
Kuyruklu  
Dirsek

Elbow

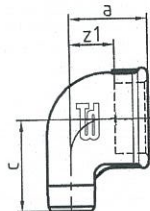

	Ölçü Size	Kod Code	Poşet Bag	Kutu Carton	Gr Gr
SYH	3/4-1/2 "	FS092R0032		150	125
GLV	3/4-1/2 "	FG092R0032		150	130

	Ölçü Size	Kod Code	a	b	c	z	z1
SYH	3/4-1/2 "	FS092R0032	30		40		18
GLV	3/4-1/2 "	FG092R0032					

	Ölçü Size	Kod Code	Poşet Bag	Kutu Carton	Gr Gr
SYH	1/2 "	FS00950002	10	90	258
GLV	1/2 "	FG00950002	10	90	305
SYH	3/4 "	FS00950003	10	50	378
GLV	3/4 "	FG00950003	10	50	432
SYH	1 "	FS00950004		40	463
GLV	1 "	FG00950004		40	540

	Ölçü Size	Kod Code	a	c	z1	z2	s1
SYH	1/2 "	FS00950002	58	28	15	45	26
GLV	1/2 "	FG00950002					
SYH	3/4 "	FS00950003	62	33	18	47	31
GLV	3/4 "	FG00950003					
SYH	1 "	FS00950004	72	38	21	55	38
GLV	1 "	FG00950004					



## 95

ISO/EN(UA1)

90° Köşe  
Düz Rakor

Union elbows flat  
seat

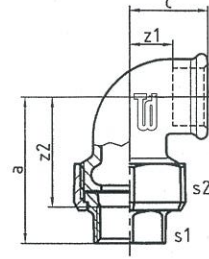

	Ölçü Size	Kod Code	Poşet Bag	Kutu Carton	Gr Gr
SYH	1/2 "	FS00960002	10	90	255
GLV	1/2 "	FG00960002	10	90	270
SYH	3/4 "	FS00960003	10	50	375
GLV	3/4 "	FG00960003	10	50	405
SYH	1 "	FS00960004		40	453
GLV	1 "	FG00960004		40	480

	Ölçü Size	Kod Code	a	c	z1	z2	s1
SYH	1/2 "	FS00960002	58	28	15	45	25
GLV	1/2 "	FG00960002					
SYH	3/4 "	FS00960003	62	33	18	47	32
GLV	3/4 "	FG00960003					
SYH	1 "	FS00960004	72	38	21	55	38
GLV	1 "	FG00960004					



## 96

ISO/EN(UA11)

90° Köşe  
Konik Rakor

Union elbow taper  
seat

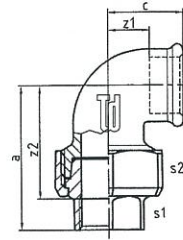

# 97

## ISO/EN(UA2)

90° Kuyruklu  
Düz Rakor

*Union elbow flat  
seat*

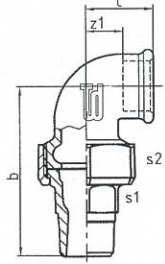

	Ölçü Size	Kod Code	Poşet Bag	Kutu Carton	Gr Gr
SYH	1/2 "	FS00970002	10	80	278
GLV	1/2 "	FG00970002	10	80	300
SYH	3/4 "	FS00970003	10	50	403
GLV	3/4 "	FG00970003	10	50	422
SYH	1 "	FS00970004		40	529
GLV	1 "	FG00970004		40	555

	Ölçü Size	Kod Code	b	c	z1	s1	s2
SYH	1/2 "	FS00970002	76	28	15	25	41
GLV	1/2 "	FG00970002					
SYH	3/4 "	FS00970003	82	33	18	31	50
GLV	3/4 "	FG00970003					
SYH	1 "	FS00970004	93	38	21	38	55
GLV	1 "	FG00970004					

# 98

## ISO/EN(UA12)

90° Kuyruklu  
Konik Rakor

*Union elbow,  
taper seat*

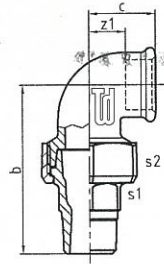

	Ölçü Size	Kod Code	Poşet Bag	Kutu Carton	Gr Gr
SYH	1/2 "	FS00980002	10	80	274
GLV	1/2 "	FG00980002	10	80	290
SYH	3/4 "	FS00980003	10	50	410
GLV	3/4 "	FG00980003	10	50	425
SYH	1 "	FS00980004		40	527
GLV	1 "	FG00980004		40	556

	Ölçü Size	Kod Code	b	c	z1	s1	s2
SYH	1/2 "	FS00980002	76	28	15	25	41
GLV	1/2 "	FG00980002					
SYH	3/4 "	FS00980003	82	33	18	31	50
GLV	3/4 "	FG00980003					
SYH	1 "	FS00980004	94	38	21	38	55
GLV	1 "	FG00980004					

	Ölçü Size	Kod Code	Poşet Bag	Kutu Carton	Gr Gr
SYH	1/2 "	FS01200002	10	300	81
GLV	1/2 "	FG01200002	10	300	85
SYH	3/4 "	FS01200003	10	150	151
GLV	3/4 "	FG01200003	10	150	158
SYH	1 "	FS01200004		100	236
GLV	1 "	FG01200004		100	248
SYH	1 1/4 "	FS01200005		50	374
GLV	1 1/4 "	FG01200005		50	399
SYH	1 1/2 "	FS01200006		40	460
GLV	1 1/2 "	FG01200006		40	484
SYH	2 "	FS01200007		20	837
GLV	2 "	FG01200007		20	856
SYH	2 1/2 "	FS01200008		12	1.227
GLV	2 1/2 "	FG01200008		12	1.271



**120**  
ISO/EN (A1/45°)  
45° Dirsek  
45° Elbow

	Ölçü Size	Kod Code	a	z
SYH	1/2 "	FS01200002	22	9
GLV	1/2 "	FG01200002		
SYH	3/4 "	FS01200003	25	10
GLV	3/4 "	FG01200003		
SYH	1 "	FS01200004	28	11
GLV	1 "	FG01200004		
SYH	1 1/4 "	FS01200005	33	14
GLV	1 1/4 "	FG01200005		
SYH	1 1/2 "	FS01200006	36	17
GLV	1 1/2 "	FG01200006		
SYH	2 "	FS01200007	43	19
GLV	2 "	FG01200007		
SYH	2 1/2 "	FS01200008	48	21
GLV	2 1/2 "	FG01200008		

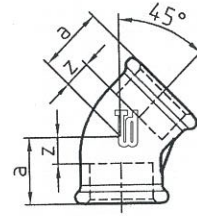

	Ölçü Size	Kod Code	Poşet Bag	Kutu Carton	Gr Gr
SYH	1/2 "	FS01210002	10	300	79
GLV	1/2 "	FG01210002	10	300	85
SYH	3/4 "	FS01210003	10	150	134
GLV	3/4 "	FG01210003	10	150	139
SYH	1 "	FS01210004	10	100	200
GLV	1 "	FG01210004	10	100	207
SYH	1 1/4 "	FS01210005		50	339
GLV	1 1/4 "	FG01210005		50	357
SYH	1 1/2 "	FS01210006		40	450
GLV	1 1/2 "	FG01210006		40	477
SYH	2 "	FS01210007		20	770
GLV	2 "	FG01210007		20	772



**121**  
ISO/EN (A4/45°)  
45° Kuyruklu  
Dirsek  
45° Elbow

	Ölçü Size	Kod Code	a	b	z
SYH	1/2 "	FS01210002	22	28	9
GLV	1/2 "	FG01210002			
SYH	3/4 "	FS01210003	25	32	10
GLV	3/4 "	FG01210003			
SYH	1 "	FS01210004	28	37	11
GLV	1 "	FG01210004			
SYH	1 1/4 "	FS01210005	33	43	14
GLV	1 1/4 "	FG01210005			
SYH	1 1/2 "	FS01210006	36	46	17
GLV	1 1/2 "	FG01210006			
SYH	2 "	FS01210007	43	55	19
GLV	2 "	FG01210007			

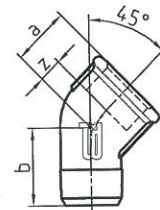

# 130

ISO/EN(B1)

Te

Tee

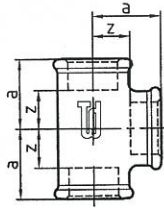

	Ölçü Size	Kod Code	Poşet Bag	Kutu Carton	Gr Gr
SYH	3/8 "	FS01300001	10	240	95
GLV	3/8 "	FG01300001	10	240	99
SYH	1/2 "	FS01300002	10	180	130
GLV	1/2 "	FG01300002	10	180	139
SYH	3/4 "	FS01300003	10	100	214
GLV	3/4 "	FG01300003	10	100	222
SYH	1 "	FS01300004	10	60	331
GLV	1 "	FG01300004	10	60	342
SYH	1 1/4 "	FS01300005		35	517
GLV	1 1/4 "	FG01300005		35	539
SYH	1 1/2 "	FS01300006		25	671
GLV	1 1/2 "	FG01300006		25	723
SYH	2 "	FS01300007		15	1.097
GLV	2 "	FG01300007		15	1.132
SYH	2 1/2 "	FS01300008		8	1.592
GLV	2 1/2 "	FG01300008		8	1.662
SYH	3 "	FS01300009		6	2.252
GLV	3 "	FG01300009		6	2.323
SYH	4 "	FS01300000		3	4.100
GLV	4 "	FG01300000		3	4.167

	Ölçü Size	Kod Code	a	z
SYH	3/8 "	FS01300001	25	15
GLV	3/8 "	FG01300001		
SYH	1/2 "	FS01300002	28	15
GLV	1/2 "	FG01300002		
SYH	3/4 "	FS01300003	33	18
GLV	3/4 "	FG01300003		
SYH	1 "	FS01300004	38	21
GLV	1 "	FG01300004		
SYH	1 1/4 "	FS01300005	45	26
GLV	1 1/4 "	FG01300005		
SYH	1 1/2 "	FS01300006	50	31
GLV	1 1/2 "	FG01300006		
SYH	2 "	FS01300007	58	34
GLV	2 "	FG01300007		
SYH	2 1/2 "	FS01300008	69	42
GLV	2 1/2 "	FG01300008		
SYH	3 "	FS01300009	78	48
GLV	3 "	FG01300009		
SYH	4 "	FS01300000	96	60
GLV	4 "	FG01300000		



	Ölçü Size	Kod Code	Poşet Bag	Kutu Carton	Gr Gr
SYH	1/2-3/4-1/2 "	FS130R0232	10	130	171
GLV	1/2-3/4-1/2 "	FG130R0232	10	130	165
SYH	3/4-1/2-1/2 "	FS130R0322	10	130	150
GLV	3/4-1/2-1/2 "	FG130R0322	10	130	165
SYH	3/4-1/2-3/4 "	FS130R0323	10	100	186
GLV	3/4-1/2-3/4 "	FG130R0323	10	100	194
SYH	3/4-3/4-1/2 "	FS130R0332	10	100	175
GLV	3/4-3/4-1/2 "	FG130R0332	10	100	184
SYH	3/4-1-1/2 "	FS130R0342	10	80	228
GLV	3/4-1-1/2 "	FG130R0342	10	80	238
SYH	3/4-1-3/4 "	FS130R0343	10	80	234
GLV	3/4-1-3/4 "	FG130R0343	10	80	246
SYH	1-1/2-1/2 "	FS130R0422	10	100	195
GLV	1-1/2-1/2 "	FG130R0422	10	100	208
SYH	1-1/2-3/4 "	FS130R0423	10	100	192
GLV	1-1/2-3/4 "	FG130R0423	10	100	211
SYH	1-3/8-1 "	FS130R0414	10	100	270
GLV	1-3/8-1 "	FG130R0414	10	100	280
SYH	1-1/2-1 "	FS130R0424	10	90	207
GLV	1-1/2-1 "	FG130R0424	10	90	219
SYH	1-3/4-1/2 "	FS130R0432	10	80	225
GLV	1-3/4-1/2 "	FG130R0432	10	80	240
SYH	1-3/4-3/4 "	FS130R0433	10	80	222
GLV	1-3/4-3/4 "	FG130R0433	10	80	237
SYH	1-3/4-1 "	FS130R0434	10	70	241
GLV	1-3/4-1 "	FG130R0434	10	70	256
SYH	1-1 1/4-3/4 "	FS130R0453		50	388
GLV	1-1 1/4-3/4 "	FG130R0453		50	320
SYH	1-1 1/4-1 "	FS130R0454		50	409
GLV	1-1 1/4-1 "	FG130R0454		50	429
SYH	1 1/4-3/8-1 1/4 "	FS130R0515		30	385
GLV	1 1/4-3/8-1 1/4 "	FG130R0515		30	400
SYH	1 1/4-1/2-1 "	FS130R0524		55	294
GLV	1 1/4-1/2-1 "	FG130R0524		55	312
SYH	1 1/4-1/2-1 1/4 "	FS130R0525		55	371
GLV	1 1/4-1/2-1 1/4 "	FG130R0525		55	405
SYH	1 1/4-3/4-1 "	FS130R0534		48	325
GLV	1 1/4-3/4-1 "	FG130R0534		48	342
SYH	1 1/4-3/4-1 1/4 "	FS130R0535		55	382
GLV	1 1/4-3/4-1 1/4 "	FG130R0535		55	400
SYH	1 1/4-1-3/4 "	FS130R0543		48	380
GLV	1 1/4-1-3/4 "	FG130R0543		48	405
SYH	1 1/4-1-1 "	FS130R0544		36	410
GLV	1 1/4-1-1 "	FG130R0544		36	425
SYH	1 1/4-1-1 1/4 "	FS130R0545		50	440
GLV	1 1/4-1-1 1/4 "	FG130R0545		50	475
SYH	1 1/4-1 1/4-1 "	FS130R0554		50	495
GLV	1 1/4-1 1/4-1 "	FG130R0554		50	520
SYH	1 1/4-1 1/2-1 1/4 "	FS130R0565		30	645
GLV	1 1/4-1 1/2-1 1/4 "	FG130R0565		30	670
SYH	1 1/2-1/2-1 1/2 "	FS130R0626		45	385
GLV	1 1/2-1/2-1 1/2 "	FG130R0626		45	395
SYH	1 1/2-3/4-1 1/2 "	FS130R0636		45	413
GLV	1 1/2-3/4-1 1/2 "	FG130R0636		45	438
SYH	1 1/2-1-1 1/4 "	FS130R0645		32	518
GLV	1 1/2-1-1 1/4 "	FG130R0645		32	534
SYH	1 1/2-1-1 1/2 "	FS130R0646		30	524
GLV	1 1/2-1-1 1/2 "	FG130R0646		30	555
SYH	1 1/2-1 1/4-1 1/4 "	FS130R0655		30	625
GLV	1 1/2-1 1/4-1 1/4 "	FG130R0655		30	650
SYH	1 1/2-1 1/4-1 1/2 "	FS130R0656		30	555
GLV	1 1/2-1 1/4-1 1/2 "	FG130R0656		30	580
SYH	1 1/2-3/4-1 1/4 "	FS130R0635		32	434
GLV	1 1/2-3/4-1 1/4 "	FG130R0635		32	440
SYH	2-1/2-2 "	FS130R0727		20	784
GLV	2-1/2-2 "	FG130R0727		20	815
SYH	2-3/4-2 "	FS130R0737		20	790
GLV	2-3/4-2 "	FG130R0737		20	819

**130R**  
ISO/EN (B1)



Inegal Tee  
Tee

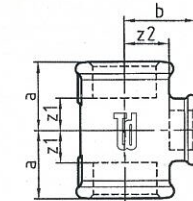
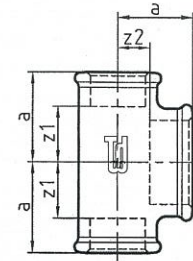
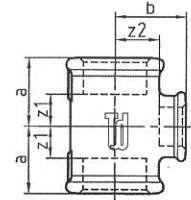

# 130R

ISO/EN(B1)

Inegal Tee

Tee

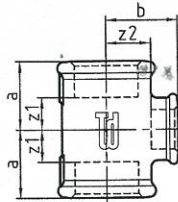
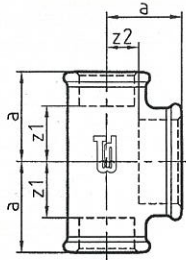
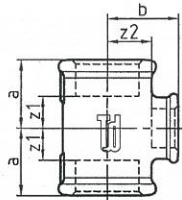

SYH	2-1-1 1/2 "	FS130R0746	20	699
GLV	2-1-1 1/2 "	FG130R0746	20	725
SYH	2-1-2 "	FS130R0747	20	893
GLV	2-1-2 "	FG130R0747	20	918
SYH	2-1 1/4-1 1/2 "	FS130R0756	20	880
GLV	2-1 1/4-1 1/2 "	FG130R0756	20	915
SYH	2-1 1/4-2 "	FS130R0757	20	817
GLV	2-1 1/4-2 "	FG130R0757	20	862
SYH	2-1 1/2-2 "	FS130R0767	20	712
GLV	2-1 1/2-2 "	FG130R0767	20	868
SYH	2-2-1 "	FS130R0774	20	1.158
GLV	2-2-1 "	FG130R0774	20	1.070
SYH	2 1/2-2-2 1/2 "	FS130R0878	12	1.370
GLV	2 1/2-2-2 1/2 "	FG130R0878	12	1.401
SYH	3-2-3 "	FS130R0979	8	2.222
GLV	3-2-3 "	FG130R0979	8	2.265

# 130R

ISO/EN(B1)  
Inegal Tee

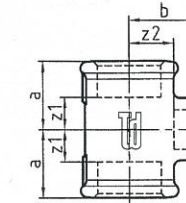
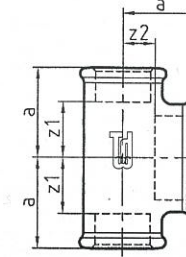
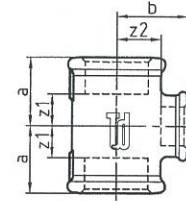

	Ölçü Size	Kod Code	a	b	c	z1	z2
SYH	1/2-3/4-1/2 "	FS130R0232	31	30		18	15
GLV	1/2-3/4-1/2 "	FG130R0232					
SYH	3/4-1/2-1/2 "	FS130R0322	30	31	28	15	18
GLV	3/4-1/2-1/2 "	FG130R0322					
SYH	3/4-1/2-3/4 "	FS130R0323	30	31		15	18
GLV	3/4-1/2-3/4 "	FG130R0323					
SYH	3/4-3/4-1/2 "	FS130R0332	33	33	31	18	18
GLV	3/4-3/4-1/2 "	FG130R0332					
SYH	3/4-1-1/2 "	FS130R0342	36	35	34	21	18
GLV	3/4-1-1/2 "	FG130R0342					
SYH	3/4-1-3/4 "	FS130R0343	36	35		21	18
GLV	3/4-1-3/4 "	FG130R0343					
SYH	1-1/2-1/2 "	FS130R0422	32	34	28	15	21
GLV	1-1/2-1/2 "	FG130R0422					
SYH	1-1/2-3/4 "	FS130R0423	32	34	30	15	21
GLV	1-1/2-3/4 "	FG130R0423					
SYH	1-3/8-1 "	FS130R0414	30	32		13	22
GLV	1-3/8-1 "	FG130R0414					
SYH	1-1/2-1 "	FS130R0424	32	34		15	21
GLV	1-1/2-1 "	FG130R0424					
SYH	1-3/4-1/2 "	FS130R0432	35	36	31	18	21
GLV	1-3/4-1/2 "	FG130R0432					
SYH	1-3/4-3/4 "	FS130R0433	35	36	33	18	21
GLV	1-3/4-3/4 "	FG130R0433					
SYH	1-3/4-1 "	FS130R0434	35	36		18	21
GLV	1-3/4-1 "	FG130R0434					
SYH	1-1 1/4-3/4 "	FS130R0453	42	40	41	25	21
GLV	1-1 1/4-3/4 "	FG130R0453					
SYH	1-1 1/4-1 "	FS130R0454	42	40		25	21
GLV	1-1 1/4-1 "	FG130R0454					
SYH	1 1/4-3/8-1 1/4 "	FS130R0515	32	36		15	27
GLV	1 1/4-3/8-1 1/4 "	FG130R0515					
SYH	1 1/4-1/2-1 "	FS130R0524	34	38	32	15	25
GLV	1 1/4-1/2-1 "	FG130R0524					
SYH	1 1/4-1/2-1 1/4 "	FS130R0525	34	38		15	25
GLV	1 1/4-1/2-1 1/4 "	FG130R0525					
SYH	1 1/4-3/4-1 "	FS130R0534	36	41	35	17	26
GLV	1 1/4-3/4-1 "	FG130R0534					
SYH	1 1/4-3/4-1 1/4 "	FS130R0535	36	41		17	26
GLV	1 1/4-3/4-1 1/4 "	FG130R0535					
SYH	1 1/4-1-3/4 "	FS130R0543	40	42	36	21	25
GLV	1 1/4-1-3/4 "	FG130R0543					
SYH	1 1/4-1-1 "	FS130R0544	40	42	38	21	25
GLV	1 1/4-1-1 "	FG130R0544					
SYH	1 1/4-1-1 1/4 "	FS130R0545	40	42		21	25
GLV	1 1/4-1-1 1/4 "	FG130R0545					
SYH	1 1/4-1 1/4-1 "	FS130R0554	45	45	42	26	26
GLV	1 1/4-1 1/4-1 "	FG130R0554					
SYH	1 1/4-1 1/2-1 1/4 "	FS130R0565	48	46		29	27
GLV	1 1/4-1 1/2-1 1/4 "	FG130R0565					
SYH	1 1/2-1/2-1 1/2 "	FS130R0626	36	42		17	29
GLV	1 1/2-1/2-1 1/2 "	FG130R0626					
SYH	1 1/2-3/4-1 1/2 "	FS130R0636	38	44		19	29
GLV	1 1/2-3/4-1 1/2 "	FG130R0636					
SYH	1 1/2-1-1 1/4 "	FS130R0645	42	46	40	23	29
GLV	1 1/2-1-1 1/4 "	FG130R0645					
SYH	1 1/2-1-1 1/2 "	FS130R0646	42	46		23	29
GLV	1 1/2-1-1 1/2 "	FG130R0646					
SYH	1 1/2-1 1/4-1 1/4 "	FS130R0655	46	48	45	27	29
GLV	1 1/2-1 1/4-1 1/4 "	FG130R0655					
SYH	1 1/2-1 1/4-1 1/2 "	FS130R0656	46	48		27	29
GLV	1 1/2-1 1/4-1 1/2 "	FG130R0656					
SYH	1 1/2-3/4-1 1/4 "	FS130R0635	38	44	36	17	29
GLV	1 1/2-3/4-1 1/4 "	FG130R0635					
SYH	2-1/2-2 "	FS130R0727	38	48		14	35
GLV	2-1/2-2 "	FG130R0727					
SYH	2-3/4-2 "	FS130R0737	40	50		16	35
GLV	2-3/4-2 "	FG130R0737					

**130R**  
ISO/EN (B1)

Inegal Tee

Tee

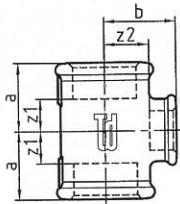
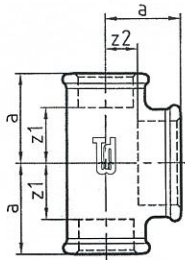
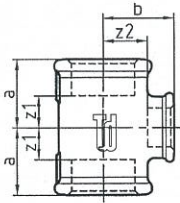

SYH	2-1-1 1/2 "	FS130R0746	44	52	42	20	35
GLV	2-1-1 1/2 "	FG130R0746					
SYH	2-1-2 "	FS130R0747	44	52		20	35
GLV	2-1-2 "	FG130R0747					
SYH	2-1 1/4-1 1/2 "	FS130R0756	48	54	46	24	35
GLV	2-1 1/4-1 1/2 "	FG130R0756					
SYH	2-1 1/4-2 "	FS130R0757	48	54		24	35
GLV	2-1 1/4-2 "	FG130R0757					
SYH	2-1 1/2-2 "	FS130R0767	52	55		28	36
GLV	2-1 1/2-2 "	FG130R0767					
SYH	2-2-1 "	FS130R0774	58	58	52	34	34
GLV	2-2-1 "	FG130R0774					
SYH	2 1/2-2-2 1/2 "	FS130R0878	61	66		34	42
GLV	2 1/2-2-2 1/2 "	FG130R0878					
SYH	3-2-3 "	FG130R0979	64	73		34	49
GLV	3-2-3 "	FG130R0979					

	Ölçü Size	Kod Code	Poşet Bag	Kutu Carton	Gr Gr
SYH	1/2 "	FS01310002	10	150	166
GLV	1/2 "	FG01310002	10	150	176
SYH	3/4 "	FS01310003	10	70	255
GLV	3/4 "	FG01310003	10	70	265
SYH	1 "	FS01310004	10	50	525
GLV	1 "	FG01310004	10	50	540
SYH	2 "	FS01310007		10	1.840
GLV	2 "	FG01310007		10	1.900



**131**  
ISO/EN(E1)

Kavisli Te  
Tee

	Ölçü Size	Kod Code	a	c	z	z3
SYH	1/2 "	FS01310002	45	24	32	11
GLV	1/2 "	FG01310002				
SYH	3/4 "	FS01310003	50	28	35	13
GLV	3/4 "	FG01310003				
SYH	1 "	FS01310004	63	33	46	16
GLV	1 "	FG01310004				
SYH	2 "	FS01310007	102	53	78	29
GLV	2 "	FG01310007				

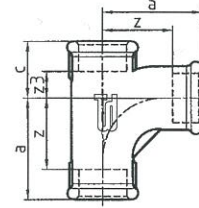

	Ölçü Size	Kod Code	Poşet Bag	Kutu Carton	Gr Gr
SYH	1/2 "	FS01800002	10	120	154
GLV	1/2 "	FG01800002	10	120	171
SYH	3/4 "	FS01800003	10	70	266
GLV	3/4 "	FG01800003	10	70	280
SYH	1 "	FS01800004		40	409
GLV	1 "	FG01800004		40	440
SYH	1 1/4 "	FS01800005		30	618
GLV	1 1/4 "	FG01800005		30	652
SYH	1 1/2 "	FS01800006		25	730
GLV	1 1/2 "	FG01800006		25	772
SYH	2 "	FS01800007		15	1.390
GLV	2 "	FG01800007		15	1.430
SYH	2 1/2 "	FS01800008		6	1.710
GLV	2 1/2 "	FG01800008		6	1.750
SYH	3 "	FS01800009		4	2.850
GLV	3 "	FG01800009		4	2.960



**180**  
ISO/EN(C1)

Kuruva  
Cross

	Ölçü Size	Kod Code	a	b	z	z1
SYH	1/2 "	FS01800002	28		15	
GLV	1/2 "	FG01800002				
SYH	3/4 "	FS01800003	33		18	
GLV	3/4 "	FG01800003				
SYH	1 "	FS01800004	38		21	
GLV	1 "	FG01800004				
SYH	1 1/4 "	FS01800005	45		26	
GLV	1 1/4 "	FG01800005				
SYH	1 1/2 "	FS01800006	50		31	
GLV	1 1/2 "	FG01800006				
SYH	2 "	FS01800007	58		34	
GLV	2 "	FG01800007				
SYH	2 1/2 "	FS01800008	69		42	
GLV	2 1/2 "	FG01800008				
SYH	3 "	FS01800009				
GLV	3 "	FG01800009				

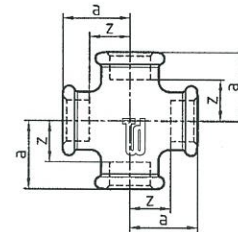



TRAKYA DÖKÜM

180R

ISO/EN(C1)

Inegal Kuruva

Cross

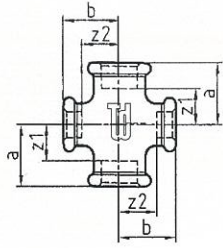

	Ölçü Size	Kod Code	Poşet Bag	Kutu Carton	Gr Gr
SYH	3/4-1/2-3/4-1/2 "	FS180R3232		80	200
GLV	3/4-1/2-3/4-1/2 "	FG180R3232		80	215
SYH	1-1/2-1-1/2 "	FS180R4242		60	270
GLV	1-1/2-1-1/2 "	FG180R4242		60	283
SYH	1-3/4-1-3/4 "	FS180R4343		60	324
GLV	1-3/4-1-3/4 "	FG180R4343		60	340
SYH	1 1/4-1-1 1/4-1 "	FS180R5454		30	482
GLV	1 1/4-1-1 1/4-1 "	FG180R5454		30	515
SYH	1 1/2-1-1 1/2-1 "	FS180R6464		25	555
GLV	1 1/2-1-1 1/2-1 "	FG180R6464		25	598

	Ölçü Size	Kod Code	a	b	z	z1	z2
SYH	3/4-1/2-3/4-1/2 "	FS180R3232	30	31	15	18	
GLV	3/4-1/2-3/4-1/2 "	FG180R3232					
SYH	1-1/2-1-1/2 "	FS180R4242	32	34	15	21	
GLV	1-1/2-1-1/2 "	FG180R4242					
SYH	1-3/4-1-3/4 "	FS180R4343	35	36	18	21	
GLV	1-3/4-1-3/4 "	FG180R4343					
SYH	1 1/4-1-1 1/4-1 "	FS180R5454	40	42	21	25	
GLV	1 1/4-1-1 1/4-1 "	FG180R5454					
SYH	1 1/2-1-1 1/2-1 "	FS180R6464	42	46	23	29	
GLV	1 1/2-1-1 1/2-1 "	FG180R6464					

# 240

ISO/EN (M2)

Manşon  
Redüksiyon

Socket



	Ölçü Size	Kod Code	Poşet Bag	Kutu Carton	Gr Gr
SYH	3/4-3/8 "	FS02400031		250	90
GLV	3/4-3/8 "	FG02400031		250	116
SYH	3/4-1/2 "	FS02400032	10	250	98
GLV	3/4-1/2 "	FG02400032	10	250	102
SYH	1-1/2 "	FS02400042	10	150	168
GLV	1-1/2 "	FG02400042	10	150	176
SYH	1-3/4 "	FS02400043	10	140	173
GLV	1-3/4 "	FG02400043	10	140	180
SYH	1 1/4-3/4 "	FS02400053		100	238
GLV	1 1/4-3/4 "	FG02400053		100	251
SYH	1 1/4-1 "	FS02400054	10	100	223
GLV	1 1/4-1 "	FG02400054	10	100	234
SYH	1 1/2-1/2 "	FS02400062		70	354
GLV	1 1/2-1/2 "	FG02400062		70	367
SYH	1 1/2-3/4 "	FS02400063		70	326
GLV	1 1/2-3/4 "	FG02400063		70	340
SYH	1 1/2-1 "	FS02400064		70	317
GLV	1 1/2-1 "	FG02400064		70	325
SYH	1 1/2-1 1/4 "	FS02400065		70	282
GLV	1 1/2-1 1/4 "	FG02400065		70	303
SYH	2-1/2 "	FS02400072		50	540
GLV	2-1/2 "	FG02400072		50	565
SYH	2-3/4 "	FS02400073		45	532
GLV	2-3/4 "	FG02400073		45	547
SYH	2-1 "	FS02400074		40	511
GLV	2-1 "	FG02400074		40	521
SYH	2-1 1/4 "	FS02400075		40	464
GLV	2-1 1/4 "	FG02400075		40	480
SYH	2-1 1/2 "	FS02400076		40	440
GLV	2-1 1/2 "	FG02400076		40	462
SYH	3-2 "	FS02400097		20	1.212
GLV	3-2 "	FG02400097		20	1.231
SYH	4-2 "	FS02400007		10	1.405
GLV	4-2 "	FG02400007		10	2.103
SYH	4-3 "	FS02400009		10	2.058
GLV	4-3 "	FG02400009		10	1.625

	Ölçü Size	Kod Code	a	z2
SYH	3/4-3/8 "	FS02400031	39	14
GLV	3/4-3/8 "	FG02400031	39	11
SYH	3/4-1/2 "	FS02400032	39	11
GLV	3/4-1/2 "	FG02400032	39	11
SYH	1-1/2 "	FS02400042	45	15
GLV	1-1/2 "	FG02400042	45	15
SYH	1-3/4 "	FS02400043	45	13
GLV	1-3/4 "	FG02400043	45	13
SYH	1 1/4-3/4 "	FS02400053	50	16
GLV	1 1/4-3/4 "	FG02400053	50	16
SYH	1 1/4-1 "	FS02400054	50	14
GLV	1 1/4-1 "	FG02400054	50	14
SYH	1 1/2-1/2 "	FS02400062	55	23
GLV	1 1/2-1/2 "	FG02400062	55	23
SYH	1 1/2-3/4 "	FS02400063	55	21
GLV	1 1/2-3/4 "	FG02400063	55	21
SYH	1 1/2-1 "	FS02400064	55	19
GLV	1 1/2-1 "	FG02400064	55	19
SYH	1 1/2-1 1/4 "	FS02400065	55	17
GLV	1 1/2-1 1/4 "	FG02400065	55	17
SYH	2-1/2 "	FS02400072	65	28
GLV	2-1/2 "	FG02400072	65	28
SYH	2-3/4 "	FS02400073	65	26
GLV	2-3/4 "	FG02400073	65	26
SYH	2-1 "	FS02400074	65	24
GLV	2-1 "	FG02400074	65	24
SYH	2-1 1/4 "	FS02400075	65	22
GLV	2-1 1/4 "	FG02400075	65	22
SYH	2-1 1/2 "	FS02400076	65	22
GLV	2-1 1/2 "	FG02400076	65	22
SYH	3-2 "	FS02400097	80	26
GLV	3-2 "	FG02400097	80	26
SYH	4-2 "	FS02400007	94	34
GLV	4-2 "	FG02400007	94	34
SYH	4-3 "	FS02400009	94	28
GLV	4-3 "	FG02400009	94	28

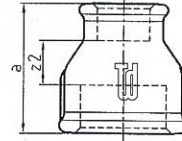

**241**

ISO/EN (N4)

Redüksiyon

Redcing bush

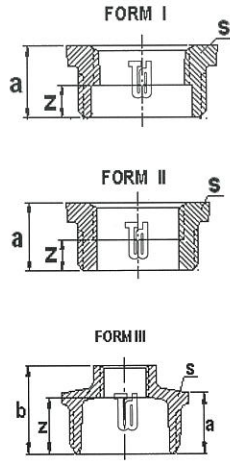

	Ölçü Size	Kod Code	Poşet Bag	Kutu Carton	Gr Gr
SYH	1/2-3/8 "	FS02410021	10	600	36
GLV	1/2-3/8 "	FG02410021	10	600	38
SYH	3/4-3/8 "	FS02410031	10	450	79
GLV	3/4-3/8 "	FG02410031	10	450	65
SYH	3/4-1/2 "	FS02410032	10	450	50
GLV	3/4-1/2 "	FG02410032	10	450	53
SYH	1-3/8 "	FS02410041	10	250	125
GLV	1-3/8 "	FG02410041	10	250	130
SYH	1-1/2 "	FS02410042	10	250	115
GLV	1-1/2 "	FG02410042	10	250	119
SYH	1-3/4 "	FS02410043	10	250	96
GLV	1-3/4 "	FG02410043	10	250	101
SYH	1 1/4-1/2 "	FS02410052	10	140	187
GLV	1 1/4-1/2 "	FG02410052	10	140	190
SYH	1 1/4-3/4 "	FS02410053	10	150	161
GLV	1 1/4-3/4 "	FG02410053	10	150	167
SYH	1 1/4-1 "	FS02410054	10	150	125
GLV	1 1/4-1 "	FG02410054	10	150	128
SYH	1 1/2-1/2 "	FS02410062	10	120	240
GLV	1 1/2-1/2 "	FG02410062	10	120	269
SYH	1 1/2-3/4 "	FS02410063	10	120	229
GLV	1 1/2-3/4 "	FG02410063	10	120	233
SYH	1 1/2-1 "	FS02410064	10	140	205
GLV	1 1/2-1 "	FG02410064	10	140	207
SYH	1 1/2-1 1/4 "	FS02410065	10	150	128
GLV	1 1/2-1 1/4 "	FG02410065	10	150	132
SYH	2-1/2 "	FS02410072		65	362
GLV	2-1/2 "	FG02410072		65	374
SYH	2-3/4 "	FS02410073		65	375
GLV	2-3/4 "	FG02410073		65	386
SYH	2-1 "	FS02410074		60	389
GLV	2-1 "	FG02410074		60	398
SYH	2-1 1/4 "	FS02410075		60	333
GLV	2-1 1/4 "	FG02410075		60	350
SYH	2-1 1/2 "	FS02410076		75	293
GLV	2-1 1/2 "	FG02410076		75	297
SYH	2 1/2-1 "	FS02410084		30	677
GLV	2 1/2-1 "	FG02410084		30	682
SYH	2 1/2-1 1/4 "	FS02410085		30	702
GLV	2 1/2-1 1/4 "	FG02410085		30	723
SYH	2 1/2-1 1/2 "	FS02410086		35	629
GLV	2 1/2-1 1/2 "	FG02410086		35	637
SYH	2 1/2-2 "	FS02410087		35	500
GLV	2 1/2-2 "	FG02410087		35	513
SYH	3-1 "	FS02410094		30	968
GLV	3-1 "	FG02410094		30	986
SYH	3-1 1/4 "	FS02410095		30	900
GLV	3-1 1/4 "	FG02410095		30	954
SYH	3-1 1/2 "	FS02410096		30	945
GLV	3-1 1/2 "	FG02410096		30	975
SYH	3-2 "	FS02410097		30	980
GLV	3-2 "	FG02410097		30	1.010
SYH	3-2 1/2 "	FS02410098		30	665
GLV	3-2 1/2 "	FG02410098		30	692
SYH	4-2 "	FS02410007		16	1.640
GLV	4-2 "	FG02410007		16	1.683
SYH	4-2 1/2 "	FS02410008		16	1.659
GLV	4-2 1/2 "	FG02410008		16	1.720
SYH	4-3 "	FS02410009		16	1.533
GLV	4-3 "	FG02410009		16	1.551



# 241

ISO/EN (N4)  
Redüksiyon  
Reducing bush



	Ölçü Size	Kod Code	a	b	s	z
SYH	1/2-3/8 "	FS02410021	24		22	14
GLV	1/2-3/8 "	FG02410021				
SYH	3/4-3/8 "	FS02410031	26		36	17
GLV	3/4-3/8 "	FG02410031				
SYH	3/4-1/2 "	FS02410032	26		30	13
GLV	3/4-1/2 "	FG02410032				
SYH	1-3/8 "	FS02410041	29		38	19
GLV	1-3/8 "	FG02410041				
SYH	1-1/2 "	FS02410042	29		38	16
GLV	1-1/2 "	FG02410042				
SYH	1-3/4 "	FS02410043	29		38	14
GLV	1-3/4 "	FG02410043				
SYH	1 1/4-1/2 "	FS02410052	31		46	18
GLV	1 1/4-1/2 "	FG02410052				
SYH	1 1/4-3/4 "	FS02410053	31		46	16
GLV	1 1/4-3/4 "	FG02410053				
SYH	1 1/4-1 "	FS02410054	31		46	16
GLV	1 1/4-1 "	FG02410054				
SYH	1 1/2-1/2 "	FS02410062	31		50	18
GLV	1 1/2-1/2 "	FG02410062				
SYH	1 1/2-3/4 "	FS02410063	31		50	16
GLV	1 1/2-3/4 "	FG02410063				
SYH	1 1/2-1 "	FS02410064	31		50	14
GLV	1 1/2-1 "	FG02410064				
SYH	1 1/2-1 1/4 "	FS02410065	31		50	12
GLV	1 1/2-1 1/4 "	FG02410065				
SYH	2-1/2 "	FS02410072	35	48	65	35
GLV	2-1/2 "	FG02410072				
SYH	2-3/4 "	FS02410073	35	48	65	33
GLV	2-3/4 "	FG02410073				
SYH	2-1 "	FS02410074	35		65	20
GLV	2-1 "	FG02410074				
SYH	2-1 1/4 "	FS02410075	35		65	18
GLV	2-1 1/4 "	FG02410075				
SYH	2-1 1/2 "	FS02410076	35		64	18
GLV	2-1 1/2 "	FG02410076				
SYH	2 1/2-1 "	FS02410084	40	54	80	37
GLV	2 1/2-1 "	FG02410084				
SYH	2 1/2-1 1/4 "	FS02410085	40	54	80	35
GLV	2 1/2-1 1/4 "	FG02410085				
SYH	2 1/2-1 1/2 "	FS02410086	40		80	21
GLV	2 1/2-1 1/2 "	FG02410086				
SYH	2 1/2-2 "	FS02410087	40		80	16
GLV	2 1/2-2 "	FG02410087				
SYH	3-1 "	FS02410094	44	59	96	42
GLV	3-1 "	FG02410094				
SYH	3-1 1/4 "	FS02410095	44	59	97	40
GLV	3-1 1/4 "	FG02410095				
SYH	3-1 1/2 "	FS02410096	44	59	97	40
GLV	3-1 1/2 "	FG02410096				
SYH	3-2 "	FS02410097	44		97	20
GLV	3-2 "	FG02410097				
SYH	3-2 1/2 "	FS02410098	44		97	17
GLV	3-2 1/2 "	FG02410098				
SYH	4-2 "	FS02410007	51	69	122	46
GLV	4-2 "	FG02410007				
SYH	4-2 1/2 "	FS02410008	51	69	122	42
GLV	4-2 1/2 "	FG02410008				
SYH	4-3 "	FS02410009	51		122	21
GLV	4-3 "	FG02410009				

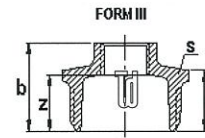
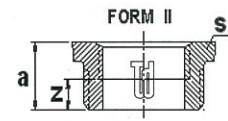
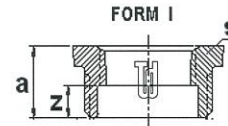

# 245

ISO/EN (N8)

Nipel  
Redüksiyon

Hexagon nipple

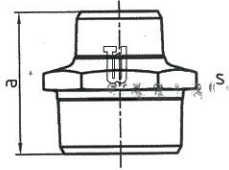

	Ölçü Size	Kod Code	Poşet Bag	Kutu Carton	Gr Gr
SYH	1/2-3/8 "	FS02450021	10	450	55
GLV	1/2-3/8 "	FG02450021	10	450	56
SYH	3/4-1/2 "	FS02450032	10	250	102
GLV	3/4-1/2 "	FG02450032	10	250	105
SYH	1-1/2 "	FS02450042	10	150	166
GLV	1-1/2 "	FG02450042	10	150	172
SYH	1-3/4 "	FS02450043	10	150	165
GLV	1-3/4 "	FG02450043	10	150	168
SYH	1 1/4-1/2 "	FS02450052		100	228
GLV	1 1/4-1/2 "	FG02450052		100	237
SYH	1 1/4-3/4 "	FS02450053		100	246
GLV	1 1/4-3/4 "	FG02450053		100	250
SYH	1 1/4-1 "	FS02450054	10	100	294
GLV	1 1/4-1 "	FG02450054	10	100	305
SYH	1 1/2-3/4 "	FS02450063		90	540
GLV	1 1/2-3/4 "	FG02450063		90	548
SYH	1 1/2-1 "	FS02450064	10	90	263
GLV	1 1/2-1 "	FG02450064	10	90	276
SYH	1 1/2-1 1/4 "	FS02450065		90	279
GLV	1 1/2-1 1/4 "	FG02450065		90	280
SYH	2-1 "	FS02450074		45	397
GLV	2-1 "	FG02450074		45	410
SYH	2-1 1/4 "	FS02450075		45	522
GLV	2-1 1/4 "	FG02450075		45	541
SYH	2-1 1/2 "	FS02450076		45	540
GLV	2-1 1/2 "	FG02450076		45	550
SYH	2 1/2-2 "	FS02450087		20	961
GLV	2 1/2-2 "	FG02450087		20	991
SYH	3-2 "	FS02450097		15	1.296
GLV	3-2 "	FG02450097		15	1.314
SYH	3-2 1/2 "	FS02450098		15	1.390
GLV	3-2 1/2 "	FG02450098		15	1.405
SYH	4-3 "	FS02450009		10	1.060
GLV	4-3 "	FG02450009		10	1.072

	Ölçü Size	Kod Code	a	s
SYH	1/2-3/8 "	FS02450021	44	22
GLV	1/2-3/8 "	FG02450021		
SYH	3/4-1/2 "	FS02450032	47	30
GLV	3/4-1/2 "	FG02450032		
SYH	1-1/2 "	FS02450042	53	36
GLV	1-1/2 "	FG02450042		
SYH	1-3/4 "	FS02450043	53	36
GLV	1-3/4 "	FG02450043		
SYH	1 1/4-1/2 "	FS02450052	57	50
GLV	1 1/4-1/2 "	FG02450052		
SYH	1 1/4-3/4 "	FS02450053	57	46
GLV	1 1/4-3/4 "	FG02450053		
SYH	1 1/4-1 "	FS02450054	57	46
GLV	1 1/4-1 "	FG02450054		
SYH	1 1/2-3/4 "	FS02450063	59	60
GLV	1 1/2-3/4 "	FG02450063		
SYH	1 1/2-1 "	FS02450064	59	50
GLV	1 1/2-1 "	FG02450064		
SYH	1 1/2-1 1/4 "	FS02450065	59	50
GLV	1 1/2-1 1/4 "	FG02450065		
SYH	2-1 "	FS02450074	68	65
GLV	2-1 "	FG02450074		
SYH	2-1 1/4 "	FS02450075	68	65
GLV	2-1 1/4 "	FG02450075		
SYH	2-1 1/2 "	FS02450076	68	65
GLV	2-1 1/2 "	FG02450076		
SYH	2 1/2-2 "	FS02450087	75	90
GLV	2 1/2-2 "	FG02450087		
SYH	3-2 "	FS02450097	83	100
GLV	3-2 "	FG02450097		
SYH	3-2 1/2 "	FS02450098	83	100
GLV	3-2 1/2 "	FG02450098		
SYH	4-3 "	FS02450009	94	130
GLV	4-3 "	FG02450009		

	Ölçü Size	Kod Code	Poşet Bag	Kutu Carton	Gr Gr
SYH	1/2-3/8 "	FS02460021	10	300	75
GLV	1/2-3/8 "	FG02460021	10	300	80
SYH	3/4-1/2 "	FS02460032	10	180	110
GLV	3/4-1/2 "	FG02460032	10	180	114
SYH	1-1/2 "	FS02460042	10	100	162
GLV	1-1/2 "	FG02460042	10	100	175
SYH	1 1/2-1 "	FS02460064		60	335
GLV	1 1/2-1 "	FG02460064		60	344

	Ölçü Size	Kod Code	a	z
SYH	1/2-3/8 "	FS02460021	43	30
GLV	1/2-3/8 "	FG02460021		
SYH	3/4-1/2 "	FS02460032	48	33
GLV	3/4-1/2 "	FG02460032		
SYH	1-1/2 "	FS02460042	55	38
GLV	1-1/2 "	FG02460042		
SYH	1 1/2-1 "	FS02460064	63	44
GLV	1 1/2-1 "	FG02460064		



## 246

ISO/DIN (M4)

Manşon Dış  
İç Vidalı

Reducing  
sockets  
male/female

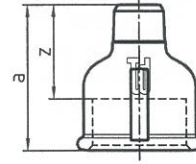



TRAKYA DÖKÜM

270

ISO/EN (M2)

Manşon Normal

Socket

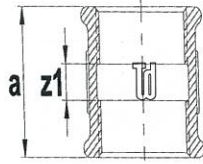

	Ölçü Size	Kod Code	Počet Bag	Kutu Carton	Gr Gr
SYH	3/8 "	FS02700001	10	500	56
GLV	3/8 "	FG02700001	10	500	57
SYH	1/2 "	FS02700002	10	370	68
GLV	1/2 "	FG02700002	10	370	73
SYH	3/4 "	FS02700003	10	200	102
GLV	3/4 "	FG02700003	10	200	108
SYH	1 "	FS02700004	10	140	169
GLV	1 "	FG02700004	10	140	179
SYH	1 1/4 "	FS02700005		100	232
GLV	1 1/4 "	FG02700005		100	253
SYH	1 1/2 "	FS02700006		70	299
GLV	1 1/2 "	FG02700006		70	315
SYH	2 "	FS02700007		35	432
GLV	2 "	FG02700007		35	443
SYH	2 1/2 "	FS02700008		24	734
GLV	2 1/2 "	FG02700008		24	761
SYH	3 "	FS02700009		15	1.029
GLV	3 "	FG02700009		15	1.064
SYH	4 "	FS02700000		7	2.342
GLV	4 "	FG02700000		7	2.370

	Ölçü Size	Kod Code	a	z1
SYH	3/8 "	FS02700001	30	10
GLV	3/8 "	FG02700001		
SYH	1/2 "	FS02700002	36	10
GLV	1/2 "	FG02700002		
SYH	3/4 "	FS02700003	39	9
GLV	3/4 "	FG02700003		
SYH	1 "	FS02700004	45	11
GLV	1 "	FG02700004		
SYH	1 1/4 "	FS02700005	50	12
GLV	1 1/4 "	FG02700005		
SYH	1 1/2 "	FS02700006	55	17
GLV	1 1/2 "	FG02700006		
SYH	2 "	FS02700007	65	17
GLV	2 "	FG02700007		
SYH	2 1/2 "	FS02700008	74	20
GLV	2 1/2 "	FG02700008		
SYH	3 "	FS02700009	80	20
GLV	3 "	FG02700009		
SYH	4 "	FS02700000	94	22
GLV	4 "	FG02700000		

## 270DT

Doğalgaz  
Test Manşonu

Socket

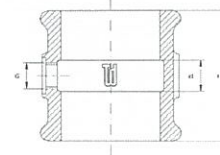

	Ölçü Size	Kod Code	Poşet Bag	Kutu Carton	Gr Gr
SYH	1"	FS270DT004	10	140	179
	Ölçü Size	Kod Code	a	z1	G
SYH	1"	FS270DT004	45	11	1/8"

	Ölçü Size	Kod Code	Poşet Bag	Kutu Carton	Gr Gr
SYH	3/8 "	FS02710001	10	500	58
GLV	3/8 "	FG02710001	10	500	60
SYH	1/2 "	FS02710002	10	370	69
GLV	1/2 "	FG02710002	10	370	72
SYH	3/4 "	FS02710003	10	200	101
GLV	3/4 "	FG02710003	10	200	108
SYH	1 "	FS02710004	10	140	155
GLV	1 "	FG02710004	10	140	180
SYH	1 1/4 "	FS02710005		100	238
GLV	1 1/4 "	FG02710005		100	250
SYH	1 1/2 "	FS02710006		70	240
GLV	1 1/2 "	FG02710006		70	310
SYH	2 "	FS02710007		35	420
GLV	2 "	FG02710007		35	440

TRAKYA DÖKÜM

## 271

ISO/EN (M2 R-L)

Manşon  
Sağ - Sol

Socket,  
Right and  
left hand  
thread

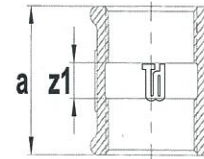

	Ölçü Size	Kod Code	a	z1
SYH	3/8 "	FS02710001	30	10
GLV	3/8 "	FG02710001		
SYH	1/2 "	FS02710002	36	10
GLV	1/2 "	FG02710002		
SYH	3/4 "	FS02710003	39	9
GLV	3/4 "	FG02710003		
SYH	1 "	FS02710004	45	11
GLV	1 "	FG02710004		
SYH	1 1/4 "	FS02710005	50	12
GLV	1 1/4 "	FG02710005		
SYH	1 1/2 "	FS02710006	55	17
GLV	1 1/2 "	FG02710006		
SYH	2 "	FS02710007	65	17
GLV	2 "	FG02710007		

**280**

ISO/EN (N8)

Nipel

Hexagon nipple

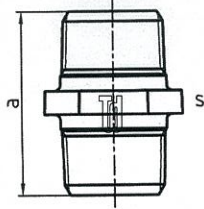

	Ölçü Size	Kod Code	Poşet Bag	Kutu Carton	Gr Gr
SYH	3/8 "	FS02800001	10	500	44
GLV	3/8 "	FG02800001	10	500	45
SYH	1/2 "	FS02800002	10	400	65
GLV	1/2 "	FG02800002	10	400	67
SYH	3/4 "	FS02800003	10	260	110
GLV	3/4 "	FG02800003	10	260	114
SYH	1 "	FS02800004	10	150	173
GLV	1 "	FG02800004	10	150	179
SYH	1 1/4 "	FS02800005	10	90	270
GLV	1 1/4 "	FG02800005	10	90	296
SYH	1 1/2 "	FS02800006		70	381
GLV	1 1/2 "	FG02800006		70	390
SYH	2 "	FS02800007		40	580
GLV	2 "	FG02800007		40	587
SYH	2 1/2 "	FS02800008		20	847
GLV	2 1/2 "	FG02800008		20	866
SYH	3 "	FS02800009		15	1.197
GLV	3 "	FG02800009		15	1.242
SYH	4 "	FS02800000		9	1.852
GLV	4 "	FG02800000		9	1.900

	Ölçü Size	Kod Code	a	s
SYH	3/8 "	FS02800001	38	22
GLV	3/8 "	FG02800001		
SYH	1/2 "	FS02800002	44	27
GLV	1/2 "	FG02800002		
SYH	3/4 "	FS02800003	47	34
GLV	3/4 "	FG02800003		
SYH	1 "	FS02800004	53	41
GLV	1 "	FG02800004		
SYH	1 1/4 "	FS02800005	57	50
GLV	1 1/4 "	FG02800005		
SYH	1 1/2 "	FS02800006	59	54
GLV	1 1/2 "	FG02800006		
SYH	2 "	FS02800007	68	69
GLV	2 "	FG02800007		
SYH	2 1/2 "	FS02800008	75	85
GLV	2 1/2 "	FG02800008		
SYH	3 "	FS02800009	83	99
GLV	3 "	FG02800009		
SYH	4 "	FS02800000	95	131
GLV	4 "	FG02800000		

	Ölçü Size	Kod Code	Poşet Bag	Kutu Carton	Gr Gr
SYH	3/8 "	FS02900001	10	500	29
GLV	3/8 "	FG02900001	10	500	31
SYH	1/2 "	FS02900002	10	600	45
GLV	1/2 "	FG02900002	10	600	48
SYH	3/4 "	FS02900003	10	400	71
GLV	3/4 "	FG02900003	10	400	75
SYH	1 "	FS02900004	10	240	114
GLV	1 "	FG02900004	10	240	119
SYH	1 1/4 "	FS02900005	10	150	177
GLV	1 1/4 "	FG02900005	10	150	184
SYH	1 1/2 "	FS02900006	10	110	221
GLV	1 1/2 "	FG02900006	10	110	232
SYH	2 "	FS02900007		70	377
GLV	2 "	FG02900007		70	392
SYH	2 1/2 "	FS02900008		30	695
GLV	2 1/2 "	FG02900008		30	702
SYH	3 "	FS02900009		25	1.119
GLV	3 "	FG02900009		25	1.131
SYH	4 "	FS02900000		15	1.598
GLV	4 "	FG02900000		15	1.604



**290**  
ISO/EN(T9)  
Tapa Dış Vidalı  
Plug, beaded

	Ölçü Size	Kod Code	c	s
SYH	3/8 "	FS02900001	24	10
GLV	3/8 "	FG02900001		
SYH	1/2 "	FS02900002	27	11
GLV	1/2 "	FG02900002		
SYH	3/4 "	FS02900003	32	17
GLV	3/4 "	FG02900003		
SYH	1 "	FS02900004	37	18
GLV	1 "	FG02900004		
SYH	1 1/4 "	FS02900005	40	22
GLV	1 1/4 "	FG02900005		
SYH	1 1/2 "	FS02900006	41	22
GLV	1 1/2 "	FG02900006		
SYH	2 "	FS02900007	48	27
GLV	2 "	FG02900007		
SYH	2 1/2 "	FS02900008	54	32
GLV	2 1/2 "	FG02900008		
SYH	3 "	FS02900009	60	37
GLV	3 "	FG02900009		
SYH	4 "	FS02900000	73	41
GLV	4 "	FG02900000		

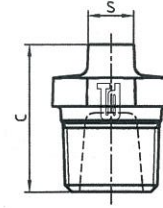

**291**

ISO/EN(T8)

Tapa Kordonsuz

Plug, plain

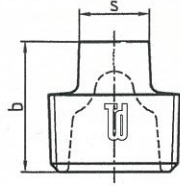

	Ölçü Size	Kod Code	Poşet Bag	Kutu Carton	Gr Gr
SYH	1/2 "	FS02910002	10	800	28
GLV	1/2 "	FG02910002	10	800	29
SYH	3/4 "	FS02910003	10	500	54
GLV	3/4 "	FG02910003	10	500	56
SYH	1 "	FS02910004	10	280	97
GLV	1 "	FG02910004	10	280	99
SYH	1 1/4 "	FS02910005	10	200	125
GLV	1 1/4 "	FG02910005	10	200	130
SYH	1 1/2 "	FS02910006	10	170	153
GLV	1 1/2 "	FG02910006	10	170	140
SYH	2 "	FS02910007		85	306
GLV	2 "	FG02910007		85	317
SYH	3 "	FS02910009		40	679
GLV	3 "	FG02910009		40	682
SYH	4 "	FS02910000		20	1.284
GLV	4 "	FG02910000		20	1.340

	Ölçü Size	Kod Code	b	s
SYH	1/2 "	FS02910002	23	11
GLV	1/2 "	FG02910002		
SYH	3/4 "	FS02910003	26	17
GLV	3/4 "	FG02910003		
SYH	1 "	FS02910004	32	19
GLV	1 "	FG02910004		
SYH	1 1/4 "	FS02910005	32	22
GLV	1 1/4 "	FG02910005		
SYH	1 1/2 "	FS02910006	33	22
GLV	1 1/2 "	FG02910006		
SYH	2 "	FS02910007	42	27
GLV	2 "	FG02910007		
SYH	3 "	FS02910009	46	32
GLV	3 "	FG02910009		
SYH	4 "	FS02910000	60	36
GLV	4 "	FG02910000		



	Ölçü Size	Kod Code	Poşet Bag	Kutu Carton	Gr Gr
SYH	1/2 "	FS03000002	10	400	63
GLV	1/2 "	FG03000002	10	400	65
SYH	3/4 "	FS03000003	10	250	90
GLV	3/4 "	FG03000003	10	250	97
SYH	1 "	FS03000004	10	190	153
GLV	1 "	FG03000004	10	190	155
SYH	1 1/4 "	FS03000005	10	120	204
GLV	1 1/4 "	FG03000005	10	120	207
SYH	1 1/2 "	FS03000006	10	110	261
GLV	1 1/2 "	FG03000006	10	110	268
SYH	2 "	FS03000007		70	328
GLV	2 "	FG03000007		70	338
SYH	2 1/2 "	FS03000008		30	869
GLV	2 1/2 "	FG03000008		30	915
SYH	3 "	FS03000009		25	985
GLV	3 "	FG03000009		25	1.028
SYH	4 "	FS03000000		13	1.625
GLV	4 "	FG03000000		13	1.648



**300**  
ISO/EN(T1)  
Kapak - Tapa  
(İç Vidalı)  
Cap

	Ölçü Size	Kod Code	a	s
SYH	1/2 "	FS03000002	23	26
GLV	1/2 "	FG03000002		
SYH	3/4 "	FS03000003	26	32
GLV	3/4 "	FG03000003		
SYH	1 "	FS03000004	30	38
GLV	1 "	FG03000004		
SYH	1 1/4 "	FS03000005	33	46
GLV	1 1/4 "	FG03000005		
SYH	1 1/2 "	FS03000006	36	52
GLV	1 1/2 "	FG03000006		
SYH	2 "	FS03000007	40	62
GLV	2 "	FG03000007		
SYH	2 1/2 "	FS03000008	43	85
GLV	2 1/2 "	FG03000008		
SYH	3 "	FS03000009	45	97
GLV	3 "	FG03000009		
SYH	4 "	FS03000000	47	123
GLV	4 "	FG03000000		

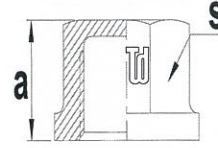

# 310

ISO/EN(P4)  
İnce Somun

Backnut



	Ölçü Size	Kod Code	Poşet Bag	Kutu Carton	Gr Gr
SYH	1/2 "	FS03100002	10	900	35
GLV	1/2 "	FG03100002	10	900	40
SYH	3/4 "	FS03100003	10	540	45
GLV	3/4 "	FG03100003	10	540	50
SYH	1 "	FS03100004	10	300	80
GLV	1 "	FG03100004	10	300	85
SYH	1 1/4 "	FS03100005		235	105
GLV	1 1/4 "	FG03100005		235	110
SYH	1 1/2 "	FS03100006		200	130
GLV	1 1/2 "	FG03100006		200	135
SYH	2 "	FS03100007		110	210
GLV	2 "	FG03100007		110	220
SYH	2 1/2 "	FS03100008		80	340
GLV	2 1/2 "	FG03100008		80	348

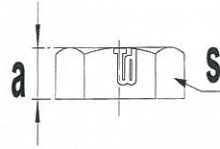

	Ölçü Size	Kod Code	a	s
SYH	1/2 "	FS03100002	9	32
GLV	1/2 "	FG03100002		
SYH	3/4 "	FS03100003	10	36
GLV	3/4 "	FG03100003		
SYH	1 "	FS03100004	11	46
GLV	1 "	FG03100004		
SYH	1 1/4 "	FS03100005	12	55
GLV	1 1/4 "	FG03100005		
SYH	1 1/2 "	FS03100006	13	60
GLV	1 1/2 "	FG03100006		
SYH	2 "	FS03100007	14	75
GLV	2 "	FG03100007		
SYH	2 1/2 "	FS03100008	16	95
GLV	2 1/2 "	FG03100008		

TRAKYA DÖKÜM

	Ölçü Size	Kod Code	Poşet Bag	Kutu Carton	Gr Gr
SYH	1/2 "	FS03300002	10	130	210
GLV	1/2 "	FG03300002	10	130	215
SYH	3/4 "	FS03300003	10	80	325
GLV	3/4 "	FG03300003	10	80	310
SYH	1 "	FS03300004	10	70	382
GLV	1 "	FG03300004	10	70	395
SYH	1 1/4 "	FS03300005		40	605
GLV	1 1/4 "	FG03300005		40	671
SYH	1 1/2 "	FS03300006		35	680
GLV	1 1/2 "	FG03300006		35	749
SYH	2 "	FS03300007		20	995
GLV	2 "	FG03300007		20	1.015
SYH	2 1/2 "	FS03300008		12	1.805
GLV	2 1/2 "	FG03300008		12	1.850
SYH	3 "	FS03300009		10	2.575
GLV	3 "	FG03300009		10	2.630



## 330

ISO/EN(U1)

Düz Rakor

Union,  
flat seat

	Ölçü Size	Kod Code	a	z1	s1	s2	s3
SYH	1/2 "	FS03300002	48	22	26	42	26
GLV	1/2 "	FG03300002					
SYH	3/4 "	FS03300003	52	22	31	50	31
GLV	3/4 "	FG03300003					
SYH	1 "	FS03300004	59	25	38	55	38
GLV	1 "	FG03300004					
SYH	1 1/4 "	FS03300005	65	27	48	68	48
GLV	1 1/4 "	FG03300005					
SYH	1 1/2 "	FS03300006	70	32	54	75	54
GLV	1 1/2 "	FG03300006					
SYH	2 "	FS03300007	80	30	66	90	65
GLV	2 "	FG03300007					
SYH	2 1/2 "	FS03300008	85	31	83	110	83
GLV	2 1/2 "	FG03300008					
SYH	3 "	FS03300009	95	35	96	130	97
GLV	3 "	FG03300009					

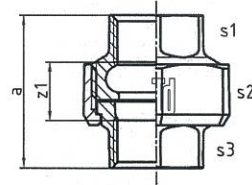

	Ölçü Size	Kod Code	Poşet Bag	Kutu Carton	Gr Gr
SYH	1/2 "	FS03310002	10	120	242
GLV	1/2 "	FG03310002	10	120	262
SYH	3/4 "	FS03310003	10	80	340
GLV	3/4 "	FG03310003	10	80	359
SYH	1 "	FS03310004		60	436
GLV	1 "	FG03310004		60	405
SYH	1 1/4 "	FS03310005		35	823
GLV	1 1/4 "	FG03310005		35	805
SYH	1 1/2 "	FS03310006		30	878
GLV	1 1/2 "	FG03310006		30	855
SYH	2 "	FS03310007		15	1.295
GLV	2 "	FG03310007		15	1.220



## 331

ISO/EN(U2)

Kuyruklu  
Düz Rakor

Union,  
flat seat

	Ölçü Size	Kod Code	b	z2	s1	s2	s3
SYH	1/2 "	FS03310002	66	53	26	42	26
GLV	1/2 "	FG03310002					
SYH	3/4 "	FS03310003	72	57	31	50	31
GLV	3/4 "	FG03310003					
SYH	1 "	FS03310004	80	63	38	55	38
GLV	1 "	FG03310004					
SYH	1 1/4 "	FS03310005	90	71	48	68	47
GLV	1 1/4 "	FG03310005					
SYH	1 1/2 "	FS03310006	95	76	54	75	53
GLV	1 1/2 "	FG03310006					
SYH	2 "	FS03310007	106	82	66	90	65
GLV	2 "	FG03310007					

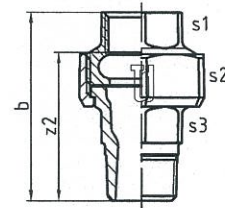

# 340

ISO/EN(U11)

Konik Rakor

Union,  
taper seat

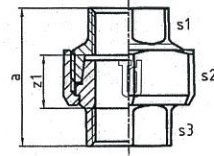

	Ölçü Size	Kod Code	Poşet Bag	Kutu Carton	Gr Gr
SYH	1/2 "	FS03400002	10	130	211
GLV	1/2 "	FG03400002	10	130	226
SYH	3/4 "	FS03400003	10	80	305
GLV	3/4 "	FG03400003	10	80	321
SYH	1 "	FS03400004	10	70	349
GLV	1 "	FG03400004	10	70	359
SYH	1 1/4 "	FS03400005		40	620
GLV	1 1/4 "	FG03400005		40	636
SYH	1 1/2 "	FS03400006		35	666
GLV	1 1/2 "	FG03400006		35	681
SYH	2 "	FS03400007		20	973
GLV	2 "	FG03400007		20	1.009
SYH	2 1/2 "	FS03400008		12	1.597
GLV	2 1/2 "	FG03400008		12	1.654
SYH	3 "	FS03400009		10	2.353
GLV	3 "	FG03400009		10	2.413
SYH	4 "	FS03400000		4	3.138
GLV	4 "	FG03400000		4	3.263

	Ölçü Size	Kod Code	a	z1	s1	s2	s3
SYH	1/2 "	FS03400002	48	22	26	42	26
GLV	1/2 "	FG03400002					
SYH	3/4 "	FS03400003	52	22	31	50	31
GLV	3/4 "	FG03400003					
SYH	1 "	FS03400004	58	24	38	55	38
GLV	1 "	FG03400004					
SYH	1 1/4 "	FS03400005	65	27	48	68	48
GLV	1 1/4 "	FG03400005					
SYH	1 1/2 "	FS03400006	70	32	54	75	54
GLV	1 1/2 "	FG03400006					
SYH	2 "	FS03400007	78	30	65	90	65
GLV	2 "	FG03400007					
SYH	2 1/2 "	FS03400008	85	31	85	110	85
GLV	2 1/2 "	FG03400008					
SYH	3 "	FS03400009	95	35	95	130	95
GLV	3 "	FG03400009					
SYH	4 "	FS03400000	110	38	122	150	122
GLV	4 "	FG03400000					

**341**

ISO/EN(U12)

 Kuyruklu Konik  
Rakor

 Union,  
taper seat

	Ölçü Size	Kod Code	Poşet Bag	Kutu Carton	Gr Gr
SYH	1/2 "	FS03410002	10	120	225
GLV	1/2 "	FG03410002	10	120	244
SYH	3/4 "	FS03410003	10	80	320
GLV	3/4 "	FG03410003	10	80	335
SYH	1 "	FS03410004		60	403
GLV	1 "	FG03410004		60	416
SYH	1 1/4 "	FS03410005		35	786
GLV	1 1/4 "	FG03410005		35	812
SYH	1 1/2 "	FS03410006		30	812
GLV	1 1/2 "	FG03410006		30	835
SYH	2 "	FS03410007		15	1.220
GLV	2 "	FG03410007		15	1.265
SYH	2 1/2 "	FS03410008		10	1.500
GLV	2 1/2 "	FG03410008		10	2.300
SYH	3 "	FS03410009		5	3.000
GLV	3 "	FG03410009		5	3.089
SYH	4 "	FS03410000		4	4.135
GLV	4 "	FG03410000		4	4.250

	Ölçü Size	Kod Code	b	z2	s1	s2	s3
SYH	1/2 "	FS03410002	66	53	26	42	26
GLV	1/2 "	FG03410002					
SYH	3/4 "	FS03410003	72	57	31	50	31
GLV	3/4 "	FG03410003					
SYH	1 "	FS03410004	80	63	38	55	38
GLV	1 "	FG03410004					
SYH	1 1/4 "	FS03410005	90	71	48	68	47
GLV	1 1/4 "	FG03410005					
SYH	1 1/2 "	FS03410006	95	76	54	75	53
GLV	1 1/2 "	FG03410006					
SYH	2 "	FS03410007	106	82	65	90	65
GLV	2 "	FG03410007					
SYH	2 1/2 "	FS03410008	122	95	85	110	85
GLV	2 1/2 "	FG03410008					
SYH	3 "	FS03410009	130	100	95	130	95
GLV	3 "	FG03410009					
SYH	4 "	FS03410000	153	117	122	150	120
GLV	4 "	FG03410000					

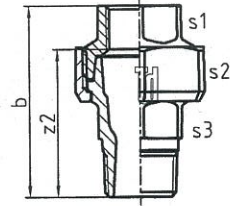

# 370

## Düz Rakor Dişli

### Union bush

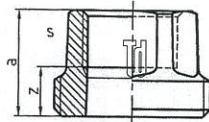
**Ölçü**  
Size

**Kod**  
Code

**Poşet**  
Bag

**Kutu**  
Carton

**Gr**  
Gr

**Gew.374 » G«**

	Ölçü Size		Kod Code	Poşet Bag	Kutu Carton	Gr Gr
SYH	1/2 "	1	FS03700002		350	85
GLV	1/2 "	1	FG03700002		350	90
SYH	3/4 "	1	FS03700003		250	100
GLV	3/4 "	1	FG03700003		250	110
SYH	1 "	2	FS03700004		190	135
GLV	1 "	2	FG03700004		190	140
SYH	1 1/4 "	2	FS03700005		100	215
GLV	1 1/4 "	2	FG03700005		100	220
SYH	1 1/2 "	2	FS03700006		80	280
GLV	1 1/2 "	2	FG03700006		80	285
SYH	2 "	3	FS03700007		50	445
GLV	2 "	3	FG03700007		50	455
SYH	2 1/2 "	4	FS03700008		30	780
GLV	2 1/2 "	4	FG03700008		30	810
SYH	3 "	4	FS03700009		20	885
GLV	3 "	4	FG03700009		20	1000

**Ölçü**  
Size

**Kod**  
Code

**a**
**z**
**s**
**Gew.374 » G«**

	Ölçü Size		Kod Code	a	z	s	
SYH	1/2 "	1	FS03700002	25	12	26	6 köşe
GLV	1/2 "	1	FG03700002				6 köşe
SYH	3/4 "	1	FS03700003	28	13	31	6 köşe
GLV	3/4 "	1	FG03700003				6 köşe
SYH	1 "	2	FS03700004	31	14	38	6 köşe
GLV	1 "	2	FG03700004				6 köşe
SYH	1 1/4 "	2	FS03700005	33	14	48	6 köşe
GLV	1 1/4 "	2	FG03700005				6 köşe
SYH	1 1/2 "	2	FS03700006	36	17	54	6 köşe
GLV	1 1/2 "	2	FG03700006				6 köşe
SYH	2 "	3	FS03700007	42	18	66	6 köşe
GLV	2 "	3	FG03700007				6 köşe
SYH	2 1/2 "	4	FS03700008	46	19	84	8 köşe
GLV	2 1/2 "	4	FG03700008				8 köşe
SYH	3 "	4	FS03700009	52	22	95	8 köşe
GLV	3 "	4	FG03700009				8 köşe

370 374 371 372

# 371

## Düz Rakor Nipeli

### Union end

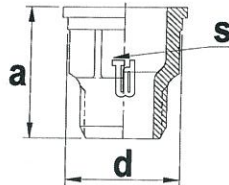
**Ölçü**  
Size

**Kod**  
Code

**Poşet**  
Bag

**Kutu**  
Carton

**Gr**  
Gr

**Gew.374 » G«**

	Ölçü Size		Kod Code	Poşet Bag	Kutu Carton	Gr Gr
SYH	1/2 "	1	FS03710002		350	80
GLV	1/2 "	1	FG03710002		350	85
SYH	3/4 "	1	FS03710003		250	95
GLV	3/4 "	1	FG03710003		250	100
SYH	1 "	2	FS03710004		160	150
GLV	1 "	2	FG03710004		160	155
SYH	1 1/4 "	2	FS03710005		80	330
GLV	1 1/4 "	2	FG03710005		80	340
SYH	1 1/2 "	2	FS03710006		75	340
GLV	1 1/2 "	2	FG03710006		75	355
SYH	2 "	3	FS03710007		40	485
GLV	2 "	3	FG03710007		40	515

**Ölçü**  
Size

**Kod**  
Code

**a**
**d**
**s**
**Gew.374 » G«**

	Ölçü Size		Kod Code	a	d	s	
SYH	1/2 "	1	FS03710002	40	31.8	26	6 köşe
GLV	1/2 "	1	FG03710002				6 köşe
SYH	3/4 "	1	FS03710003	42	35.8	31	6 köşe
GLV	3/4 "	1	FG03710003				6 köşe
SYH	1 "	2	FS03710004	47	41.3	38	6 köşe
GLV	1 "	2	FG03710004				6 köşe
SYH	1 1/4 "	2	FS03710005	55	52.7	47	6 köşe
GLV	1 1/4 "	2	FG03710005				6 köşe
SYH	1 1/2 "	2	FS03710006	58	58.7	53	6 köşe
GLV	1 1/2 "	2	FG03710006				6 köşe
SYH	2 "	3	FS03710007	63	73.7	65	6 köşe
GLV	2 "	3	FG03710007				6 köşe

**372**

 Düz Rakor  
Faturalı

Union end



Ölçü Size	Kod Code	Poşet Bag	Kutu Carton	Gr Gr
<b>Gew.374 » G«</b>				
SYH 1/2 "-1 "	1	FS0372002A	400	60
GLV 1/2 "-1 "	1	FG0372002A	400	65
SYH 1/2 "-1 1/8 "	1	FS0372002B	400	60
GLV 1/2 "-1 1/8 "	1	FG0372002B	400	65
SYH 3/4 "-1 1/4 "	1	FS0372003C	350	70
GLV 3/4 "-1 1/4 "	1	FG0372003C	350	80
SYH 1 "-1 1/2 "	2	FS0372004D	300	90
GLV 1 "-1 1/2 "	2	FG0372004D	300	95
SYH 1 1/4 "-2 "	2	FS0372005E	150	165
GLV 1 1/4 "-2 "	2	FG0372005E	150	170
SYH 1 1/2 "-2 1/4 "	2	FS0372006F	110	170
GLV 1 1/2 "-2 1/4 "	2	FG0372006F	110	195
SYH 2 "-2 3/4 "	3	FS0372007G	70	290
GLV 2 "-2 3/4 "	3	FG0372007G	70	305
SYH 2 1/2 "-3 1/2 "	4	FS0372008H	35	545
GLV 2 1/2 "-3 1/2 "	4	FG0372008H	35	560
SYH 3 "-4 "	4	FS0372009J	25	655
GLV 3 "-4 "	4	FG0372009J	25	675

Ölçü Size	Kod Code	a	d	z	s	
<b>Gew.374 » G«</b>						
SYH 1/2 "-1 "	1	FS0372002A	22	27.1	7	26
GLV 1/2 "-1 "	1	FG0372002A				
SYH 1/2 "-1 1/8 "	1	FS0372002B	21	31.8	9	26
GLV 1/2 "-1 1/8 "	1	FG0372002B				
SYH 3/4 "-1 1/4 "	1	FS0372003C	22	35.8	7	31
GLV 3/4 "-1 1/4 "	1	FG0372003C				
SYH 1 "-1 1/2 "	2	FS0372004D	25	41.3	8	38
GLV 1 "-1 1/2 "	2	FG0372004D				
SYH 1 1/4 "-2 "	2	FS0372005E	30	52.7	11	48
GLV 1 1/4 "-2 "	2	FG0372005E				
SYH 1 1/2 "-2 1/4 "	2	FS0372006F	32	58.7	13	54
GLV 1 1/2 "-2 1/4 "	2	FG0372006F				
SYH 2 "-2 3/4 "	3	FS0372007G	34	73.7	10	65
GLV 2 "-2 3/4 "	3	FG0372007G				
SYH 2 1/2 "-3 1/2 "	4	FS0372008H	37	92.9	10	83
GLV 2 1/2 "-3 1/2 "	4	FG0372008H				
SYH 3 "-4 "	4	FS0372009J	41	104.7	11	97
GLV 3 "-4 "	4	FG0372009J				

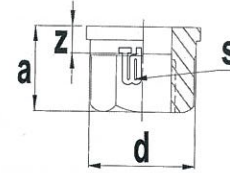

# 374

## Rakor Somunu

Union nut

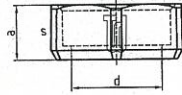

	Ölçü Size		Kod Code	Poşet Bag	Kutu Carton	Gr Gr
<b>Gew.374 » G«</b>						
SYH	1/2 "-1 "	1	FS037402AS		350	70
GLV	1/2 "-1 "	1	FG037402AS		350	75
SYH	1/2 "-1 1/8 "	1	FS037402BS		350	70
GLV	1/2 "-1 1/8 "	1	FG037402BS		350	80
SYH	3/4 "-1 1/4 "	1	FS037403CS		220	125
GLV	3/4 "-1 1/4 "	1	FG037403CS		220	130
SYH	1 "-1 1/2 "	2	FS037404DS		180	110
GLV	1 "-1 1/2 "	2	FG037404DS		180	115
SYH	1 1/4 "-2 "	2	FS037405ES		110	235
GLV	1 1/4 "-2 "	2	FG037405ES		110	240
SYH	1 1/2 "-2 1/4 "	2	FS037406FS		80	210
GLV	1 1/2 "-2 1/4 "	2	FG037406FS		80	220
SYH	2 "-2 3/4 "	3	FS037407GS		60	265
GLV	2 "-2 3/4 "	3	FG037407GS		60	285
SYH	2 1/2 "-3 1/2 "	4	FS037408HS		30	460
GLV	2 1/2 "-3 1/2 "	4	FG037408HS		30	480
SYH	3 "-4 "	4	FS037409JS		20	935
GLV	3 "-4 "	4	FG037409JS		20	945

	Ölçü Size		Kod Code	a	d	s	
<b>Gew.374 » G«</b>							
SYH	1/2 "-1 "	1	FS037402AS	18	27.5	41	6 köşe
GLV	1/2 "-1 "	1	FG037402AS				6 köşe
SYH	1/2 "-1 1/8 "	1	FS037402BS	19	32	42	6 köşe
GLV	1/2 "-1 1/8 "	1	FG037402BS				6 köşe
SYH	3/4 "-1 1/4 "	1	FS037403CS	20	36	50	6 köşe
GLV	3/4 "-1 1/4 "	1	FG037403CS				6 köşe
SYH	1 "-1 1/2 "	2	FS037404DS	22	41.5	55	6 köşe
GLV	1 "-1 1/2 "	2	FG037404DS				6 köşe
SYH	1 1/4 "-2 "	2	FS037405ES	24	53	68	8 köşe
GLV	1 1/4 "-2 "	2	FG037405ES				8 köşe
SYH	1 1/2 "-2 1/4 "	2	FS037406FS	25	59	75	8 köşe
GLV	1 1/2 "-2 1/4 "	2	FG037406FS				8 köşe
SYH	2 "-2 3/4 "	3	FS037407GS	27	74	90	8 köşe
GLV	2 "-2 3/4 "	3	FG037407GS				8 köşe
SYH	2 1/2 "-3 1/2 "	4	FS037408HS	30	92.5	110	8 köşe
GLV	2 1/2 "-3 1/2 "	4	FG037408HS				8 köşe
SYH	3 "-4 "	4	FS037409JS	31	105	130	8 köşe
GLV	3 "-4 "	4	FG037409JS				8 köşe



	Ölçü Size	Kod Code	Poşet Bag	Kutu Carton	Gr Gr
SYH	1/2 "	FS529A0002	10	350	76
GLV	1/2 "	FG529A0002	10	350	79
SYH	3/4 "	FS529A0003	10	200	105
GLV	3/4 "	FG529A0003	10	200	106
SYH	1 "	FS529A0004	10	150	150
GLV	1 "	FG529A0004	10	150	172

	Ölçü Size	Kod Code	a	z
SYH	1/2 "	FS529A0002	43	30
GLV	1/2 "	FG529A0002		
SYH	3/4 "	FS529A0003	48	33
GLV	3/4 "	FG529A0003		
SYH	1 "	FS529A0004	55	38
GLV	1 "	FG529A0004		



## 529a

ISO/EN (M4)

Manşon  
(İç-Dış Dişli)

Extension socket

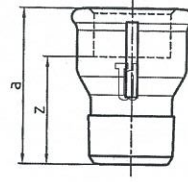

	Ölçü Size	Kod Code	H	H1	s1	G	R
SYH	1 "	FS330SB0006	68	57	46	1 "	1 "



## 330 SB Sayaç Bağlama Rakoru ve Somunu

Sayaç Bağlama  
Rakoru ve Somunu

Union

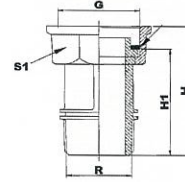

	Ölçü Size	Kod Code	Poşet Bag	Kutu Carton	Gr Gr
SYH	1 - 1 1/2 "	FS330PB0004		150	270
SYH	1 1/4 - 2 "	FS330PB0005		100	400

	Ölçü Size	Kod Code	a	z	s2	s3
SYH	1 - 1 1/2 "	FS330PB0004	39	17	55	38
SYH	1 1/4 - 2 "	FS330PB0005	44	19	68	48



## 330 PB Pompa Bağlama Rakoru ve Somunu

Pompa Bağlama  
Rakoru ve Somunu

Union

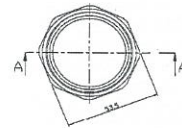
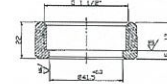

## Kutuların ölçülerimiz 36 x 24 x 21 cm. dir.

- The size of boxes is 36 x 24 x 21 cm.



**Ambalaj sistemimiz 80x120 cm ebadındaki palet üzerine yerleştirilmiş her biri 36x24x21 cm boyutlarında 36 kutudan oluşmaktadır.**

Bu katalogdaki fiyat ve parça ağırlık değerleri sadece genel amaçlı olup nominal değerlerdir. Teknik sebeplerden dolayı parça ağırlıkları değişebilir. Trakya Döküm daha önceden bilgi vermeksizi bu katalogdaki değerlerde değişiklik yapma hakkını saklı tutar.

**Td packaging system consists of 36 boxes measuring 36 x 24 x 21 cm, placed on a pallet measuring 80 x 120 cm**

- The index and piece weight values in this catalogue are for general purposes only. The piece weight given are nominal values. Differences in piece weights can occur due to technical reasons. Trakya Döküm reserves the right to make changes in values of this catalogue without providing any information beforehand.

**TÜRK STANDARDLARI ENSTİTÜSÜ**  
**TÜRK STANDARDLARINA UYGUNLUK BELGESİ**  
**TURKISH STANDARDS INSTITUTION**  
**CERTIFICATE OF CONFORMITY TO TURKISH STANDARDS**

**TSE**

Markanın Tanımı TSE	Description of the Mark TSE
BELEGE NUMARASI REFERENCE NUMBER OF LICENCE	14.10.2027SE-744
BELGENİN İLK VERİLMİŞ TARİHİ DATE OF FIRST ISSUE OF LICENCE	23.05.1985
BELGENİN SON GEÇERLİLİK TARİHİ LICENCE VALID UNTIL	23.05.2013
BELGE SAHİBİ KURULUŞUN ADI NAME OF THE LICENCE HOLDER	TRAKYA DÖKÜM SAN. VE TİC. A.Ş.
BELGE SAHİBİ KURULUŞUN ADRESİ ADDRESS OF THE LICENCE HOLDER	BOYÜKÖZERE CADDESİ SOYAK BİNASI NO.38 KAT 2 MECİDİYEKÖY İSTANBUL
ÜRETİM YERİ ADI NAME OF THE MANUFACTURING PLACE	TRAKYA DÖKÜM SAN. VE TİC. A.Ş.
ÜRETİM YERİ ADRESİ ADDRESS OF THE MANUFACTURING PLACE	İSTANBUL-EDİRNE KARAYOLU ÜZERİNDE BOYÜKÖZARISTIRAN KOYU LÜLEBURGAZ KIRKLARELİ
İPTAL EDİLEN BELEGE NUMARASI (varsa) INDICATION OF SUPERSEDED LICENCE (if any)	TD
TESCİLLİ TİCARİ MARKASI REGISTERED TRADE MARK	TS 11 EN 10242 / 28.04.2000
İLGİLİ TÜRK STANDARDI RELATED TURKISH STANDARD	
BELEGE KAPSAMI SCOPE OF LICENCE	

BELEGE KAPSAMI  
SCOPE OF LICENCE

DIRSEK TS 11 EN 10242 A1 3/8" Fe-A (dahil) kadar  
TS 11 EN 10242 A1 2 1/2" Zn-A (dahil) kadar  
DIRSEK TS 11 EN 10242 A1 4" Zn-A (dahil) kadar  
TS 11 EN 10242 A4 3/8" Fe-A (dahil) kadar  
DIRSEK TS 11 EN 10242 A4 1/2" Fe-A (dahil) kadar  
TS 11 EN 10242 A4 2" Zn-A (dahil) kadar  
DIRSEK TS 11 EN 10242 A4 4" Zn-A (dahil) kadar  
TS 11 EN 10242 B1 1/2" Fe-A (dahil) kadar  
TS 11 EN 10242 B1 2" Zn-A (dahil) kadar  
TS 11 EN 10242 B1 2 1/2" Zn-A (dahil) kadar  
TS 11 EN 10242 B1 4" Zn-A (dahil) kadar  
REDÜKSİYONLU TS 11 EN 10242 C1 1/2" Zn-A (dahil) kadar  
TS 11 EN 10242 C1 2" Zn-A (dahil) kadar  
UZUN DEVE BÖTÜRÜ TS 11 EN 10242 D1 1/2" Zn-A (dahil) kadar

M.05/2012  
Makina Sektörü Belgeleme Müdürü

**TÜRK STANDARDLARI ENSTİTÜSÜ**  
**TÜRK STANDARDLARINA UYGUNLUK BELGESİ**  
**TURKISH STANDARDS INSTITUTION**  
**CERTIFICATE OF CONFORMITY TO TURKISH STANDARDS**

**TSE**

Markanın Tanımı TSE	Description of the Mark TSE
BELEGE NUMARASI REFERENCE NUMBER OF LICENCE	14.10.2027SE-744
BELGENİN İLK VERİLMİŞ TARİHİ DATE OF FIRST ISSUE OF LICENCE	23.05.1985
BELGENİN SON GEÇERLİLİK TARİHİ LICENCE VALID UNTIL	23.05.2013
BELGE SAHİBİ KURULUŞUN ADI NAME OF THE LICENCE HOLDER	TRAKYA DÖKÜM SAN. VE TİC. A.Ş.
BELGE SAHİBİ KURULUŞUN ADRESİ ADDRESS OF THE LICENCE HOLDER	BOYÜKÖZERE CADDESİ SOYAK BİNASI NO.38 KAT 2 MECİDİYEKÖY İSTANBUL
ÜRETİM YERİ ADI NAME OF THE MANUFACTURING PLACE	TRAKYA DÖKÜM SAN. VE TİC. A.Ş.
ÜRETİM YERİ ADRESİ ADDRESS OF THE MANUFACTURING PLACE	İSTANBUL-EDİRNE KARAYOLU ÜZERİNDE BOYÜKÖZARISTIRAN KOYU LÜLEBURGAZ KIRKLARELİ
İPTAL EDİLEN BELEGE NUMARASI (varsa) INDICATION OF SUPERSEDED LICENCE (if any)	TD
TESCİLLİ TİCARİ MARKASI REGISTERED TRADE MARK	
İLGİLİ TÜRK STANDARDI RELATED TURKISH STANDARD	TS 11 EN 10242 / 28.04.2000
BELEGE KAPSAMI SCOPE OF LICENCE	

BELEGE KAPSAMI  
SCOPE OF LICENCE

Elbows from TS 11 EN 10242 A1 3/8" Fe-A (included) to TS 11 EN 10242 A1 2 1/2" Zn-A (included)

Elbows from TS 11 EN 10242 A1 1/2" Zn-A (included) to TS 11 EN 10242 A1 4" Zn-A (included)

Elbow TS 11 EN 10242 A1450 1/2" Zn-A

Elbows from TS 11 EN 10242 A4 3/8" Fe-A (included) to TS 11 EN 10242 A4 1 1/2" Fe-A (included)

Elbows from TS 11 EN 10242 A4 1/2" Zn-A (included) to TS 11 EN 10242 A4 4" Zn-A (included)

Tees from TS 11 EN 10242 B1 1/2" Fe-A (included) to TS 11 EN 10242 B1 2" Fe-A (included)

Tees from TS 11 EN 10242 B1 3/8" Zn-A (included) to TS 11 EN 10242 B1 2" Zn-A (included)

Reducers less TS 11 EN 10242 B1 2 1/2" X 2" Zn-A

**РОССИЙСКАЯ ФЕДЕРАЦИЯ**  
**СЕРТИФИКАТ СООТВЕТСТВИЯ**  
**(обязательная сертификация)**

№ С-TR.ATZ.B.02750

ЗАЯВИТЕЛЬ «Trakya Döküm Sanayi ve Ticaret A.Ş.»  
 Буyükкариштин Мевкхи 39750 Лүлебургаз Киркларели, Турция  
 Адрес: Буyükкариштин Мевкхи 39750 Лүлебургаз Киркларели, Турция

ИЗГОТОВИТЕЛЬ «Trakya Döküm Sanayi ve Ticaret A.Ş.»  
 Буyükкариштин Мевкхи 39750 Лүлебургаз Киркларели, Турция  
 Адрес: Буyükкариштин Мевкхи 39750 Лүлебургаз Киркларели, Турция

ОРГАН ПО СЕРТИФИКАЦИИ «Тест-Мастер» (ООО «Тест-Мастер»)  
 Москва, ул.Дмитрия Ульянова д.39, телефонный адрес: +7 (495) 988-12312, факс: +7 (495) 988-12312, ОГРН: 5027003891

ПОДТВЕРЖДАЕТ ЧТО  
 Сертификат соответствует требованиям Технического Регламента Таможенного Союза в отношении продукции диаметром 1/6"-6". Сертификат выдан.

СООТВЕТСТВУЕТ ТРЕБОВАНИЯМ  
 ТЕХНИЧЕСКОГО РЕГЛАМЕНТА  
 (ТЕХНИЧЕСКИХ РЕГЛАМЕНТОВ)  
 Технический регламент "О безопасности машин и оборудования" от 15.09.2009г. № 753

ПРОВЕДЕННЫЕ ИССЛЕДОВАНИЯ  
 (ИСПЫТАНИЯ) И ИЗМЕРЕНИЯ  
 Протокол испытаний № 547-11-10/11 от 25.10.2011 г.  
 ИЛАНО "Мастерсер", рег. РОСС RU.0001.51A054 от 15.12.2008 г.

ПРЕДСТАВЛЕННЫЕ ДОКУМЕНТЫ  
 Сертификат соответствия требованиям Технического Регламента Таможенного Союза в отношении продукции диаметром 1/6"-6". Сертификат выдан.

СРОК ДЕЙСТВИЯ СЕРТИФИКАТА СООТВЕТСТВИЯ  
 Руководитель органа по сертификации: К.С. Дубовицкий  
 Эксперт (эксперты): А.Н. Лукьянов

код ОК 005 (ОКП) 36 4790  
 код ЕКПС  
 код ТН ВЭД России 7307 19 100 0

**KALITE YÖNETİM SİSTEMİ BELGESİ**  
**QUALITY MANAGEMENT SYSTEM CERTIFICATE**

Partner of **ISO/Net**

Belge No / Certificate No: KY-008-02/KG-92/09-R

Belge Tarihi / Date of Certificate: 14/07/2009

Belgeyi Kuruluş Adı, Adresi  
 Name and Address of the certified organization

TRAKYA DÖKÜM SAN. VE TİC. A.Ş.  
 BUYÜKÖZARISTIRAN MEVKİHİ LÜLEBURGAZ 39750-  
 KIRKLARELİ / TÜRKİYE

Belge Kapsamı:  
 TS EN ISO 9001:2008

SCOPE OF THE CERTIFICATE:  
 TS EN ISO 9001:2008

ÜRETİMİ

- İHAM VE İSLENMİŞ OLARAK GRI, SPERO, SİYAH TEMPER DÖKÜM PARÇA  
 - TEMPER DÖKÜM BORU EKLEME PARÇALARI

PRODUCTION OF  
 - GREY, DUCTILE AND BLACKHEART M/ AS ROUGH AND MACHINE PARTS  
 - MALLEABLE CAST IRON PIPE FITTING

**K - Q TSE-ISO-EN 9000**

**TÜV**  
 TÜV Rheinland/  
 Berlin-Brandenburg

**CERTIFICATE**

TRAKYA DÖKÜM SAN VE TİC A.S.

in

Büyükkarıştiran

has evidenced, that the company is able to produce threaded pipe fittings according to EN 10242 subject to design symbol A. In accordance with the TÜV Rheinland Substances Prospectus for Fittings in malleable cast iron, Edition 7/98.

Cologne, 28. Juli 1998

Dpl.-Ing. F.-J. Steinborn  
 Zentralabteilung Werkstoffe und Verarbeitung

**KALITE YÖNETİM SİSTEMİ BELGESİ**  
**QUALITY MANAGEMENT SYSTEM CERTIFICATE**

Partner of **ISO/Net**

TÜRK STANDARDLARI ENSTİTÜSÜ  
 bu belge ile

TURKISH STANDARDS INSTITUTION  
 hereby certifies that the organization

TRAKYA DÖKÜM SAN. VE TİC. A.Ş.  
 BUYÜKÖZARISTIRAN MEVKİHİ LÜLEBURGAZ 39750-  
 KIRKLARELİ / TÜRKİYE

TRAKYA DÖKÜM SAN. VE TİC. A.Ş.  
 BUYÜKÖZARISTIRAN MEVKİHİ LÜLEBURGAZ 39750-  
 KIRKLARELİ / TÜRKİYE

karşılığında TS EN ISO 9001:2008 şartlarına uygun bir KALITE YÖNETİM SİSTEMİNE sahip olduğunu onaylar.

has a QUALITY MANAGEMENT SYSTEM which fulfills the requirements of the TS EN ISO 9001:2008

Belge kapsamı Ek'te verilmiştir

Scope of the certificate is given in annex

**K - Q TSE-ISO-EN 9000**

**TÜRK STANDARDLARI ENSTİTÜSÜ**  
 TURKISH STANDARDS INSTITUTION

Sistem Belgeleme Müdürü  
 System Certification Director

Personel ve Sistem Belgeleme Merkezi Başkanı  
 Head of System and Personnel Certification Department

Belge No / Certificate No  
 KY-008-02/KG-92/09-R

Belge Tarihi / Date of Certificate  
 14.07.2009

Geçerlilik Tarihi / Valid Until  
 14.07.2012

Bu belge belgelendirmeye şartlarına uygunluk sağladığına dairdir. Bu belgeyi belgeleme kuruluşu tarafından onaylanmıştır. Bu belge belgelendirmeye şartlarına uygunluk sağladığına dairdir. Bu belgeyi belgeleme kuruluşu tarafından onaylanmıştır.

Türk Standards Institution, has been accredited by the Turkish Accreditation Agency TÜRKAK.

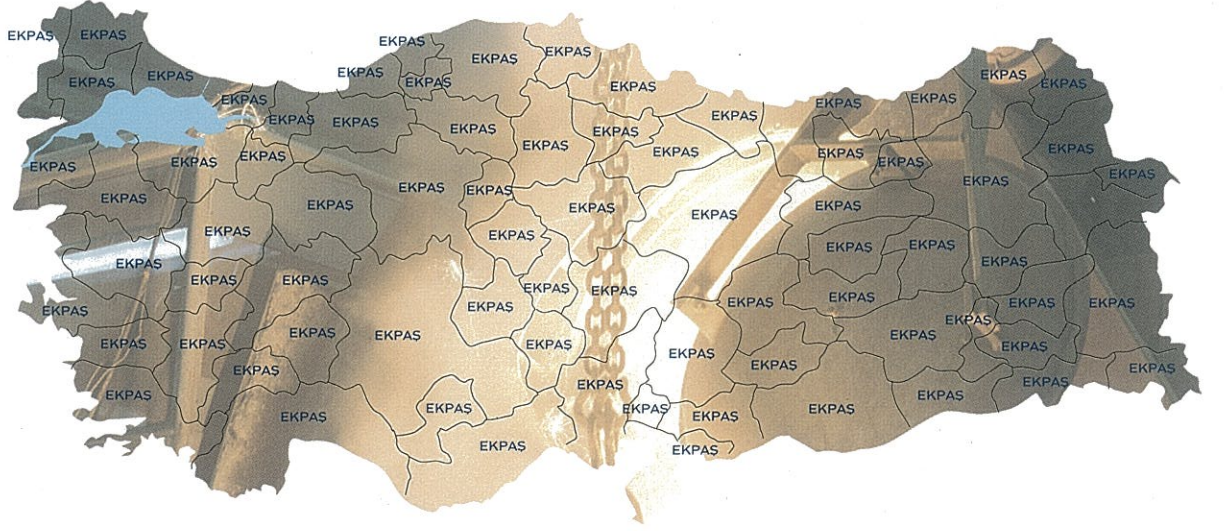

**ekpaş**<sup>®</sup>  
ekpas.com.tr

**EKPAŞ EKLEME PARÇALARI TİCARETİ A.Ş.**

Ortaklar Cad. Bahçeler Sk. No:14 Soyak Binası  
Mecidiyeköy 34387 İstanbul  
Tel: (0212) 315 53 00 pbx Faks: (0212) 274 41 00 - 274 41 06  
www.ekpas.com.tr - e-mail: ekpasinfo@ekpas.com.tr

EKPAŞ bir **SOYAK** HOLDİNG kuruluşudur.

